

Hot New Products

Lanyards



STARS & STRIPES LANYARD

OPTIMA™

The First Family of Premium Lanyards

Badge Holders



ALL-WEATHER "ZIP-LOCK" BADGE HOLDERS



POLYCARBONATE ACCESS CARD DISPENSERS



CREDENTIAL WALLET HOLDERS



RIGID PLASTIC MULTI-CARD HOLDER

Badge & Key Reels



TRANSLUCENT COLORED BADGE REELS



HEAVY-DUTY KEY REEL W/ CHAIN CORD

Strap Clips

STRAP CLIP W/ NARROW STRAP FOR SWIPE READERS



CUSTOMIZABLE LOGOCLIP™

RETRACTABLE LANYARD



Slot Punches



HAND-HELD

STAPLER-STYLE

TABLE-TOP

Electric Slot Punches are ideal for thicker ID cards such as Proximity, Weigand, and Smart Cards.

Hand-Held Slot Punches

A. 3943-1000
Hand-Held Slot Punch -
Slot Size: $\frac{1}{8} \times \frac{1}{2}$ " (3 x 12.5mm)

B. 3943-1010
Hand-Held Slot Punch with
Adjustable Centering Guide -
Slot Size: $\frac{1}{8} \times \frac{1}{2}$ " (3 x 12.5mm)

C. 3943-1100
Hand-Held Hole Punch -
Hole Size: $\frac{3}{16}$ " (5mm)

Stapler-Style Slot Punches

D. 3943-1020
Stapler-Style Slot Punch with
Adjustable Centering Guide -
Slot receptacle
Slot Size: $\frac{1}{8} \times .550$ " (3 x 14mm)

E. 3943-2000
Stapler-Style Slot Punch -
Slot receptacle
Slot Size: $\frac{1}{8} \times .550$ " (3 x 14mm)

Slot Punches

Ideal for cutting precise
holes into any ID card
for easy wear with
a variety of
badge attachments!

Table-Top Slot Punches

F. 3943-1500
Table-Top Slot Punch with
Adjustable Centering Guides -
Slot Size: $\frac{1}{8} \times \frac{1}{2}$ " (3 x 12.5mm)

G. 3943-1600*
Heavy-Duty Electric Slot
Punch (110V) - Foot switch
and adjustable centering guides
Slot Size: $\frac{1}{8} \times \frac{9}{16}$ " (3 x 14mm)

*Also available:

3943-1605 - 220 Volt

H. 3943-1601
Standard Electric Slot
Punch (110V) - Foot switch
and adjustable centering guides
Slot Size: $\frac{1}{8} \times \frac{9}{16}$ " (3 x 14mm)

Film-Based Photo ID Systems & Cameras



All-Photo

A. 3300-1000

ID-200 Hand-Held All-Photo ID Camera - This portable camera operates manually and includes both a removable battery-operated flash and pistol grip. Its twin-imaging capability produces two high-quality, "full-right" all-photo ID cards in color or B&W. It is equipped with a fixed-distance view finder, subject framing capability, exposure adjustment, and tripod socket.

Note: Requires pre-printed data cards.

B. 3320-9015*

Polaroid Horizontal Format ID-100 System (110V) - Includes camera, base, photo die cutter, laminator, and is designed for table-top operation. It features a built-in flash and a sophisticated LED indicator panel that outlines step-by-step operation and eliminates procedural errors. The ID-100 produces two high-quality ID cards of the same individual or one each of two separate people in either color or B&W. Camera head folds back against stand for storage and portability.

*Also available:

3320-9010 - Vertical Format

Passport

C. 3305-2000

M-200 Hand-Held Passport Camera - Self-cocking shutter, view finder, hot shoe, X-sync, tripod socket, and pistol grip. This Passport/ID Camera is ideal where space is limited for operation and storage. Built-in view finder graphics help determine correct head size for passport or photo ID; two images per sheet of film. Compact and efficient, a great value. (Flash sold separately - **3946-1000**)

Composite

D. 3310-4050*

ID40 SX 4-Lens Automatic Photo ID Camera (110V) - Features built-in flash, aiming light, variable output strobe, memory, and an LED panel that outlines step-by-step operation and eliminates procedural errors. Produces one photo of four different people, two identical photos of two people, or four identical photos of the same person. This is our most economical 4-lens camera. (Stand sold separately - **3910-1400**)

*Also available:

3310-4052 - 220 Volt

Call for availability on 3310-4052.

Polaroid Film

E. 4220-6000

Polaroid® ID-UV ID Film - A medium-speed, medium-contrast, medium-grain, daylight, electronic flash, balanced color, paper-based print film with security pattern that is visible under ultraviolet light. (Twin pack, 20 exposures) PID# 625854

F. 4220-3000

Polaroid® ER Type 669 Color Film - A medium-speed, medium-contrast, medium-grain, general-purpose, paper-based print film. It provides excellent results in a wide variety of applications, and is particularly suitable for Image Transfer and Emulsion Lift. It has a soft, flattering color palette and an extended dynamic range. (Twin pack, 20 exposures) PID# 623960

Note: We offer many other types of Polaroid Film, including both sheet and pack film. Call for availability and pricing.



We Can Satisfy...

all your identification needs
with a full line of Film-Based
Photo ID Systems,
Components,
and Supplies.

Badging Accessories

Corner Rounders give all laminated documents the professional finishing touch!



Corner Rounders

A. 3335-3050
Hand-Held Corner Rounder -
 .443" (11mm) radius corners, heavy-duty
 punch with plastic housing

B. 3946-1510*
Hand-Held Corner Rounder -
 1/8" (3mm) radius corners,
 heavy-duty steel punch

*Also available:

- 3946-1520** - 1/4" (6.5mm)
radius corners
- 3946-1530** - 3/8" (9.5mm)
radius corners

Call for availability on 3946-1530.

3-in-1 Trimmer

C. 3946-3000
3-in-1 Trimmer - Manual operation
 Max. Trimming Width: 11.8" (300mm)
 Max. Trimming Thickness: .039" (1mm)
 Net Weight: 4.1 lbs. (1850g)
 Dimensions: 18.9 x 17.3 x 3.4"
 (480 x 440 x 87mm)

Back Drops

D. 3928-1###
Colored Cloth ID Backdrop -
 28 x 32" (711 x 813mm) w/ grommets
 Available Colors:

000	100	200	300	400
-----	-----	-----	-----	-----

E. 3928-2008
White Passport Cloth Backdrop -
 48 x 48" (1,219 x 1,219mm) w/ grommets

Passport Holder

F. 1840-3800
Clear Vinyl Passport Book Holder -
 Outside Dimensions: 4³/₁₆ W x 5⁷/₈" H
 (106.5 x 149mm)

Passport Folders

G. 4245-1000
Custom Passport Picture Folders -
 500/Box, minimum 100 pack

Note: Waxed coating will not stick to
 the surface of wet Polaroid®
 instant photos.

ID Badge Racks

H. 3905-0100
Horizontal All-Metal ID
Badge Rack - 40 card capacity
 Card Height: 2¹/₈" (54mm)
 Pocket Depth: 1¹/₂" (38mm)

I. 3905-0150
Vertical All-Metal ID
Badge Rack - 40 card capacity
 Card Height: 3¹/₄" (82.5mm)
 Pocket Depth: 2¹/₂" (63.5mm)

Accu-Guide

J. 3340-2000
Accu-Guide Mounting Fixture -
 Alignment fixture to adhere pressure-
 sensitive overlaminates to PVC cards



Strap Clips

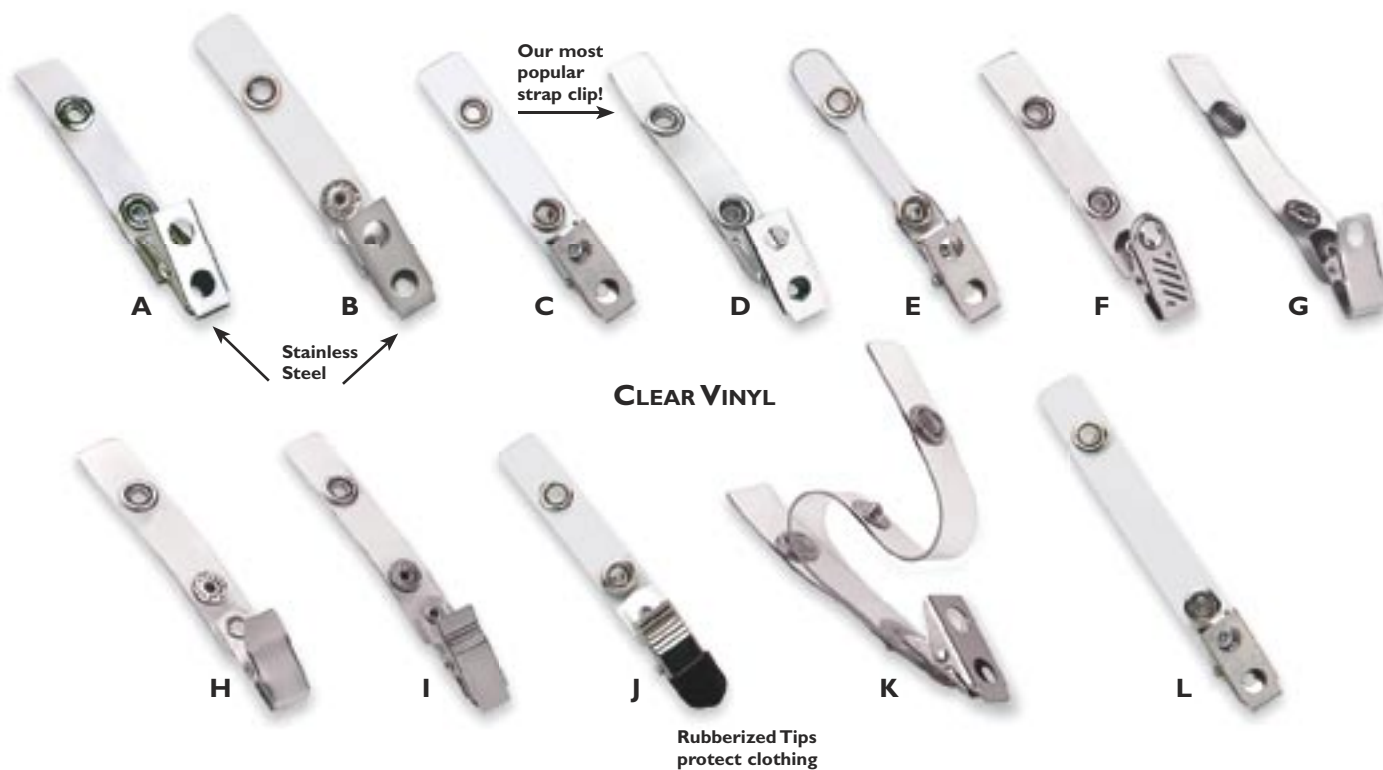

Clear Vinyl

A. 2105-1310 2-Hole Clip -

Stainless steel w/ 2³/₄" (70mm)
clear vinyl strap and nickel-plated
brass snaps

B. 2105-1320 2-Hole Clip -

Stainless steel w/ 3¹/₂" (89mm)
clear vinyl strap

C. 2105-1990 2-Hole Clip -

Nickel-plated steel w/ 2³/₄" (70mm)
clear vinyl strap and large
7/16" (11mm) snaps

D. 2105-2000* 2-Hole Clip -

Nickel-plated steel w/ 2³/₄" (70mm)
clear vinyl strap (Bag of 500)
(Old Item # - 970B)

* Also packaged in the
following quantities:

2105-1991 - Bag of 25
2105-1993 - Bag of 100
2105-1995 - Bag of 250

E. 2105-2011 2-Hole Clip -

Nickel-plated steel w/ 2³/₄" (70mm)
"narrow middle" clear vinyl strap
for swipe cards

F. 2105-2100 1-Hole Ribbed-Face Clip -

Nickel-plated steel w/ 2³/₄" (70mm)
clear vinyl strap

G. 2105-2230 1-Hole Clip -

Nickel-plated steel w/ 2³/₄" (70mm)
clear vinyl strap

H. 2105-2250 Smooth-Face Clip -

Nickel-plated steel w/ 2³/₄" (70mm)
clear vinyl strap

I. 2105-3000 Knurled Thumb-Grip Clip -

Nickel-plated steel w/ 2³/₄" (70mm)
clear vinyl strap

J. 2105-3011 Knurled Thumb-Grip Clip with Black

Rubberized Tip - Nickel-plated steel
w/ 2⁵/₈" (66.5mm) clear vinyl strap

K. 2105-3050 2-Hole Clip -

Nickel-plated steel w/ 2³/₄" (70mm) and
5⁷/₈" (149mm) clear vinyl double strap
for multiple ID cards

L. 2105-3100 2-Hole Clip -

Nickel-plated steel w/ 3¹/₂" (89mm)
clear vinyl strap

Clear Vinyl...



is the most
widely-used
strap clip
material
because
of its flexibility,
light weight, and
durability. Our choice
of styles will solve nearly
every badge attachment
requirement.

Strap Clips

CLEAR VINYL

Permanent Snap Strap Clip →

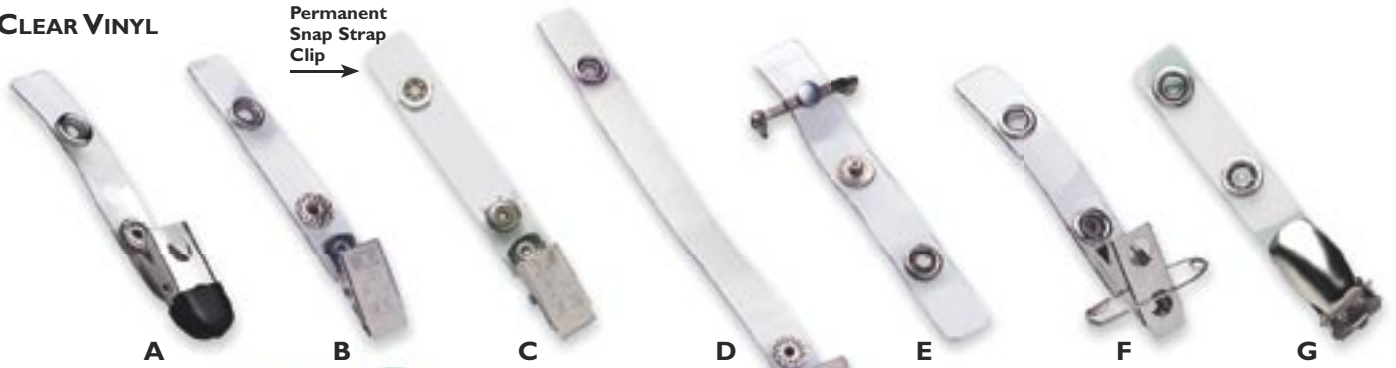

COLORED VINYL

Each style shown is available in all 6 colors!



REINFORCED VINYL

Our Most Durable Strap Clips



Clear Vinyl

A. 2105-3170
2-Hole Clip with Black Rubberized Tip - Nickel-plated steel w/ 2³/₄" (70mm) clear vinyl strap

B. 2105-3200
Embossed "U" Clip - Nickel-plated steel w/ 2³/₄" (70mm) clear vinyl strap

C. 2105-3205
Embossed "U" Clip - Nickel-plated steel w/ 2³/₄" (70mm) clear vinyl strap and permanent snap

D. 2105-3250
2-Hole Clip - Nickel-plated steel w/ 5³/₄" (146mm) clear vinyl strap

E. 2105-3300
Swivel Bar Pin - Nickel-plated steel w/ 3¹/₂" (89mm) clear vinyl strap

F. 2105-3370
2-Hole Pin-Clip Combo - Nickel-plated steel w/ 2³/₄" (70mm) clear vinyl strap
Safety Pin Length: 1¹/₄" (32mm)

G. 2105-5000
Smooth-Face Suspender Clip - Nickel-plated steel w/ 2³/₈" (66.5mm) clear vinyl strap

Colored Vinyl

H. 2105-200#
2-Hole Clip - Nickel-plated steel w/ 2³/₄" (70mm) colored vinyl strap

Available Colors:

0	1	2	4	6	8	9
---	---	---	---	---	---	---

 clear

I. 2105-205# (Strap)/ 6920-220# (Emblem)
LogoClip™ - Nickel-plated steel badge clip w/ 2³/₄" (70mm) colored vinyl strap and extra snap for custom-printed plastic logo emblem

Available Strap (2105-205#) Colors:

0	1	2	4	6	8	9
---	---	---	---	---	---	---

 clear

Available Emblem (6920-220#) Sizes:
1 - 11/16" (17mm) **4** - 15/16" (23mm)
2 - 3/4" (19mm) **5** - 1" (25.4mm)
3 - 7/8" (22mm)

Note: Please include both item numbers when ordering this product. See pages 43-45 for additional Custom Product Ordering Information.

J. 2105-500#
Smooth-Face Suspender Clip - Nickel-plated steel w/ 2³/₄" (70mm) colored vinyl strap

Available Colors:

0	1	2	4	6	8	9
---	---	---	---	---	---	---

 clear

Reinforced Vinyl

K. 2120-1000
Smooth-Face Suspender Clip - Nickel-plated steel w/ 2³/₄" (70mm) opaque white, filament-reinforced vinyl strap

L. 2120-1010
2-Hole Clip - Nickel-plated steel w/ 2³/₄" (70mm) opaque white, filament-reinforced vinyl strap



LogoClip™

Add a promotional message or logo to this popular attachment!

Strap Clips

MYLAR

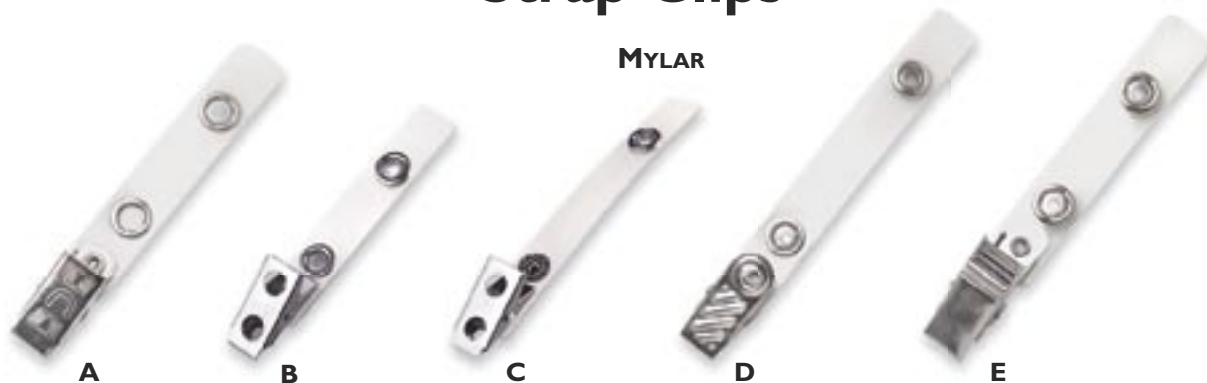

NYLON



PLASTIC



Mylar

A. 2110-1050
Embossed "U" Clip -
 Nickel-plated steel w/ 2³/₄" (70mm)
 opaque white mylar strap

B. 2110-1100
2-Hole Clip -
 Nickel-plated steel w/ 2³/₄" (70mm)
 clear mylar strap

C. 2110-1150
2-Hole Clip -
 Nickel-plated steel w/ 4" (101.5mm)
 clear mylar strap

D. 2110-1210
1-Hole Ribbed-Face Clip -
 Nickel-plated steel w/ 3¹/₂" (89mm)
 clear mylar strap

E. 2110-1255
Knurled Thumb-Grip Clip -
 Nickel-plated steel w/ 2³/₄" (70mm)
 clear mylar strap

Nylon

F. 2115-0408
1-Hole Pin-Clip Combo with
Steel Spring - Grey high-impact plastic
 w/ 2³/₈" (60.5mm) frosted, molded nylon strap
 Safety Pin Length: 1¹/₄" (32mm)

G. 2115-1000
2-Hole Clip -
 Nickel-plated steel w/ 2³/₄" (70mm)
 frosted, molded nylon strap

H. 2105-1500
Smooth-Face Suspender Clip with
Finger Lip - Nickel-plated steel w/ 2⁷/₁₆"
 (62mm) frosted, molded nylon strap

I. 2105-1501
Smooth-Face Suspender Clip with
Finger Lip - Nickel-plated steel
 w/ 2⁷/₁₆" (62mm) frosted, molded
 nylon strap and steel snaps

Plastic

J. 2115-060#
Smooth-Face Suspender Clip -
 Colored plastic w/ 2¹/₄" (57mm)
 frosted, molded nylon strap

Available Colors:

1	2	5	6	8	9
---	---	---	---	---	---

 white

Non-Stock Item.
 Minimum Quantity May Apply.
 Call for Details.

K. 2115-200#
Knurled Thumb-Grip Clip -
 Colored all-plastic w/ 3¹/₈" (79.5mm)
 molded, plastic Delrin® strap

Available Colors:

1	2	4	5	6	8	9
---	---	---	---	---	---	---

 white

Call for availability on 2115-2004 and 2115-2005.

L. 2115-400#
1-Hole Clip with Steel Spring -
 Colored high-impact plastic w/ 2³/₈" (60.5mm)
 frosted, molded nylon strap

Available Colors:

0	1	2	6	8	9
---	---	---	---	---	---

 grey white

Plastic Strap Clips

are lightweight and come
 in a variety of colors.
 They can be used to visually
 identify different divisions,
 departments, titles, or simply to
 match color schemes or logos.



Luggage Tags & Attachments



A
**LUGGAGE TAG
HOLDERS**

**FLEXIBLE PLASTIC
LOOP STRAPS**



C



D



E



F

CHAIN ATTACHMENTS

are available in several lengths, finishes, and bead sizes.

Luggage Tag Holders

A. 1840-620#

Colored Molded Rigid-Plastic Luggage Tag Holder - Clear protective face plate, holds business cards, back side can be custom-printed (Luggage Strap sold separately)

Available Colors:



B. 1845-200#

Colored Semi-Rigid Vinyl Luggage Tag Holder - Clear vinyl face, holds business cards, back side can be custom-printed (Luggage Strap sold separately)

Available Colors:



Call for availability on 1845-2002, 1845-2004, 1845-2006, and 1845-2009.

Flexible Plastic Loop Straps

C. 2410-20##*

6" (152.5mm) Colored Flexible Plastic Loop Strap

Available Colors:

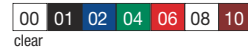

*Also available:

2410-21## - 9" (228.5mm) length (same colors as above)

Chain Attachments

D. 2450-1050*

4" (101.5mm) No. 3 (2.3mm Bead) Nickel-Plated Steel Ball Chain - w/ nickel-plated steel connector

*Also available:

2450-1070 - No. 6, 3.2mm Bead

E. 2450-1020*

4 1/2" (114mm) No. 3 (2.3mm Bead) Nickel-Plated Steel Ball Chain - w/ nickel-plated steel connector

*Also available in:

2450-1000 - No. 6, 3.2mm Bead

F. 2450-1080*

5" (127mm) No. 3 (2.3mm Bead) Nickel-Plated Steel Ball Chain - w/ nickel-plated steel connector

*Also available:

2450-1090 - No. 6, 3.2mm Bead



Luggage Tag Holders

Can be custom-printed with logos, phone numbers, website addresses, or other messages.

Flexible Plastic Loops

are available in 6" (152.5mm) and 9" (228.5mm) lengths.

These versatile loops come in a variety of colors and are an inexpensive way to attach tags to luggage, briefcases, golf bags, or any carry bag.



Luggage Tags & Attachments



Semi-Rigid Plastic Luggage Straps

A. 2430-100#
5⁷/₈" (149mm) Colored Vinyl "T" Lock Luggage Strap -
 Dimensions: 5⁷/₈ x 3³/₈" (149 x 9.5mm)

Available Colors:



B. 2430-20##
7³/₈" (187.5mm) Colored Plastic Dual-Post Luggage Strap -
 Dimensions: 7³/₈ x 3³/₈" (187.5 x 9.5mm)

Available Colors:



Call for availability on 2430-2003.

C. 2430-20##
7³/₈" (187.5mm) Colored Plastic Post and Notch Luggage Strap -
 Simulated edge stitching
 Dimensions: 7³/₈ x 3³/₈" (187.5 x 9.5mm)

Available Colors:



Leather Luggage Straps

D. 2420-100#
4³/₄" (120.5mm) Colored Genuine Leather Luggage Strap -
 Brass-plated steel buckle, 5 adjustment holes
 Dimensions: 4³/₄ x 5¹/₁₆" (120.5 x 8mm)
 (Old Item # - 996)

Available Colors:



E. 2420-1031*
6¹/₈" (156mm) Black Genuine Leather Luggage Strap -
 Brass-plated steel buckle, 3 adjustment holes
 Dimensions: 6¹/₈ x 3³/₈" (156 x 9.5mm)

*Also available:

2420-1038 - White

F. 2420-1041
6" (152.5mm) Black Genuine Leather Luggage Strap -
 Brass-plated steel buckle, 2 adjustment holes
 Dimensions: 6 x 3³/₈" (152.5 x 9.5mm)

G. 2420-1051*
7" (178mm) Black Genuine Leather Luggage Strap -
 Brass-plated steel buckle, 5 adjustment holes
 Dimensions: 7 x 5¹/₁₆" (178 x 8mm)

*Also available:

2420-1058 - White

H. 2420-107#
5³/₈" (136.5mm) Colored Genuine Leather Luggage Strap -
 Nickel-plated steel buckle, 3 adjustment holes
 Dimensions: 5³/₈ x 3³/₈" (136.5 x 9.5mm)

Available Colors:



*Also available:

2440-2101 - Black w/ nickel-plated steel buckle

Call for availability on 2420-1070, 2420-1071, and 2420-1078.

I. 2420-2101*
7" (178mm) Black Genuine Leather Executive Luggage Strap -
 Brass-plated steel buckle, 3 adjustment holes
 Dimensions: 7 x 1¹/₂" (178 x 12.5mm)

*Also available in:

2420-2108 - White

Leatherette Luggage Straps

J. 2440-200#*
5¹/₂" (140mm) Colored Leatherette (Reinforced Vinyl) Luggage Strap -
 Brass-plated steel buckle, 5 adjustment holes
 Dimensions: 5¹/₂ x 1¹/₂" (140 x 12.5mm)

Available Colors:



*Also available:

2440-2101 - Black w/ nickel-plated steel buckle

K. 2440-2052
7" (178mm) Blue Leatherette (Reinforced Vinyl) Luggage Strap -
 Brass-plated steel buckle, 3 adjustment holes
 Dimensions: 7 x 1¹/₂" (178 x 12.5mm)

Genuine Leather Straps

provide an "Executive" look and are a durable and secure way to attach tags to luggage or briefcases. Available in a wide selection of lengths and colors.



Neckwear



Steel Beaded Neck Chains

A. 2125-1500*
30" (762mm) Nickel-Plated Steel Beaded Neck Chain with Connector
 (No. 3, 2.3mm bead)
 (Old Item # - 930)

*Also available in the following lengths:

2125-1000 - 24" (609.5mm)
2125-2000 - 36" (914.5mm)
2125-3000 - 40" (1,016mm)

Call for availability on 2125-3000.

B. 2125-1510*
30" (762mm) "Nickel-Free" Steel Beaded Neck Chain with Connector
 (No. 3, 2.3mm bead)

*Also available in the following length:
2125-2010 - 36" (914.5mm)

C. 2125-1550
30" (762mm) Brass-Plated Steel Beaded Neck Chain with Connector
 (No. 3, 2.3mm bead)

Strap Adaptor

D. 2140-1000
Neck Chain Strap Adaptor - 3³/₈" (86mm) clear vinyl strap
 (chain not included)

Elastic Neck Cords

E. 2140-15##
30" (762mm) Colored Elastic Neck Cord - w/ nickel-plated steel barbed ends

Available Colors:



Call for availability on 2140-1510, 2140-1525, and 2140-1535.



Beaded Neck Chains

are available in both steel and plastic and come in many different lengths and bead sizes. These practical and attractive items are used for a wide variety of purposes.

Vinyl Break-Away Neck Straps

F. 2135-0050*
27" (686mm) Frosted-Vinyl Break-Away Neck Strap - w/ snap closure

*Also available in the following length:

2135-0100 - 37" (940mm)

Call for availability on 2135-0100.

G. 2135-2000
36" (914.5mm) Clear Vinyl Break-Away Tubular Strap - w/ plastic rod connector

Colored Steel Beaded Neck Chains

H. 2125-16##
30" (762mm) Metallic Colored Electro-Static Finish Steel Beaded Neck Chain with Connector
 (No. 3, 2.3mm bead)

Available Colors:



Neckwear & Wristwear



Colored Plastic Beaded Neck Chains

A. 2130-1008
30" (762mm) White Plastic Beaded Neck Chain with Nickel-Plated Steel Connector
 (2.5mm bead)

B. 2130-400#
38" (965mm) Colored Plastic Beaded Neck Chain with Nickel-Plated Steel Connector
 (4mm bead)

Available Colors:

0	1	2	3	4	6	8
---	---	---	---	---	---	---

 clear

Call for availability on 2130-4003, 2130-4004, and 2130-4006.

OPTIMA™ Wristwear

C. OptiBRAID™ Break-Away Round Woven-Nylon Wrist Key Strap -
 A sturdy multi-colored or solid-colored adjustable key ring. The OptiBRAID Wrist Strap comes standard with an imprintable OptiBRAID Slider and split ring attachment.

Available Colors:
 See color chart on page 24.

D. 5/8" (16mm) W x 14" (355.5mm) L OptiKOLOR™ Flat Woven-Nylon Wrist Key Strap - This comes standard with an adjustable wooden bead and split ring attachment. Dye sublimation or screen-printing is available to add a personalized message to your wrist strap.

Available Colors:
 Die-sub imprintable – up to six colors on each side. Can also be screen-printed – see material chart page 26.

Note: OPTIMA™ Wristwear is custom-made.
 Please call for item numbers and details.

Elastic Wrist Bands

E. 2140-220#*
Colored Elastic Wrist Band -
 w/ brass "S" hook (for key retention)
 Expandable: 5 1/2 - 9" (140 - 229mm)

Available Colors:

0	1	2	4	6	8	9
---	---	---	---	---	---	---

*Also available:
2140-225# - Wrist band w/ nickel-plated steel swivel hook

Plastic Wrist Coils

F. 2140-620#*
Colored Plastic Wrist Coil -
 w/ 7/8" (22mm) nickel-plated steel split ring and 2 3/4" (70mm) clear vinyl strap
 Expandable: 2 1/2 - 14 1/2" (63.5 - 368mm)

Available Colors:

0	1	2	4	6	8	9
---	---	---	---	---	---	---

 clear

*Also available:
2140-610# - Wrist coil w/ clear vinyl strap
2140-630# - Wrist coil w/ nickel-plated steel split ring

Wristwear

can be used in many applications: to hold keys, cards with magnetic stripes, and photo IDs. They come in several styles, from disposable elastic bands to permanent heavy-duty coils.



Badge Reels

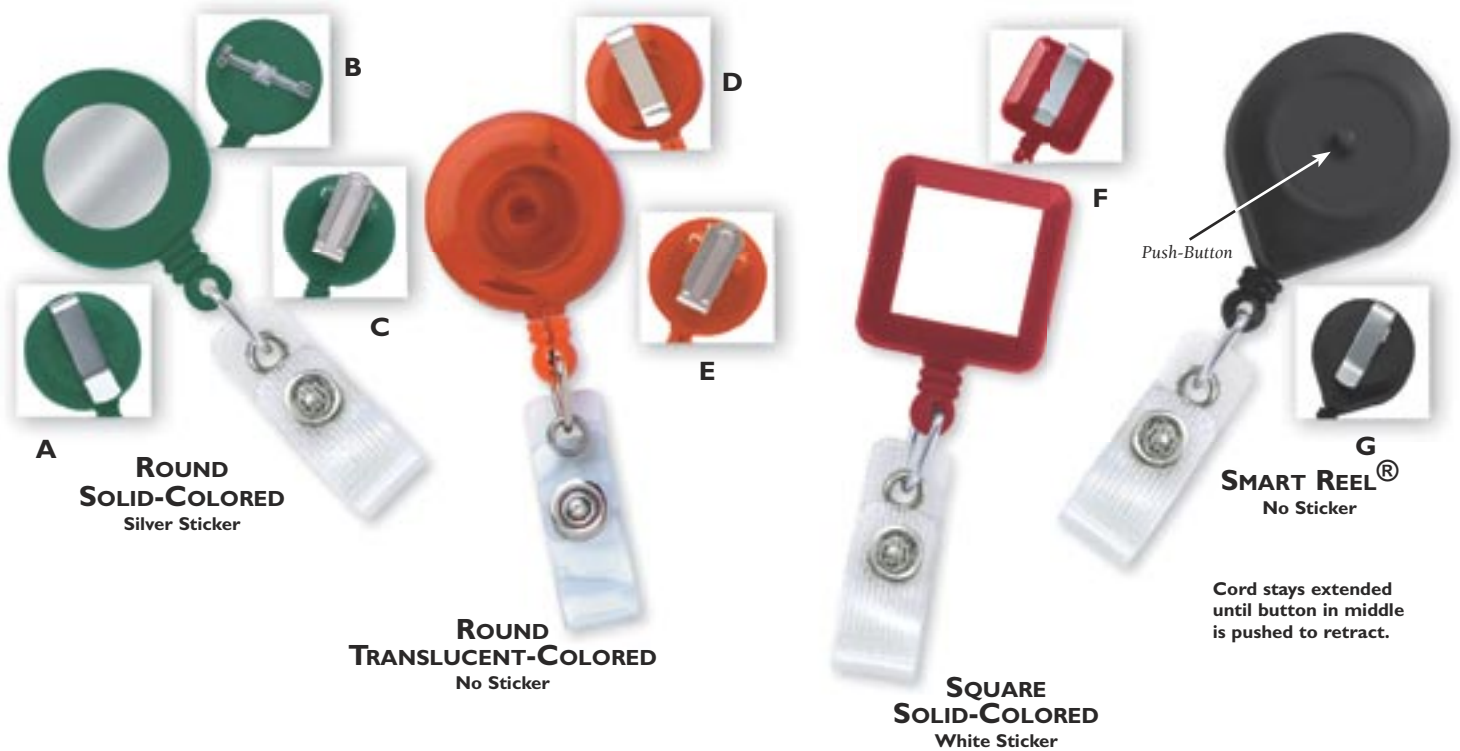

Round Solid-Colored

A. 2120-31##
Round Solid-Colored Plastic Clip-On Badge Reel - Slide-type belt clip w/ reinforced vinyl strap and silver sticker
 Reel Diameter: 1¹/₄" (32mm)
 Cord Length: 30" (762mm)

Available Colors:



Call for availability on 2120-3100, 2120-3104, 2120-3105, and 2120-3109.

B. 2120-32##
Round Solid-Colored Plastic Pin-On Badge Reel - Bar pin w/ reinforced vinyl strap with silver sticker
 Reel Diameter: 1¹/₄" (32mm)
 Cord Length: 30" (762mm)

Available Colors:



Call for availability on 2120-3200, 2120-3204, 2120-3205, and 2120-3209.

C. 2120-45##
Round Solid-Colored Plastic Clip-On Badge Reel - Spring clip w/ reinforced vinyl strap and silver sticker
 Reel Diameter: 1¹/₄" (32mm)
 Cord Length: 30" (762mm)

Available Colors:



Call for availability on 2120-3100, 2120-3104, 2120-3105, and 2120-3109.

Note: Round Solid-Colored Badge Reels are also available with clear vinyl straps.

Round Translucent-Colored

D. 2120-36##
Round Translucent-Colored Plastic Clip-On Badge Reel - Slide-type belt clip w/ clear vinyl strap and no sticker
 Reel Diameter: 1¹/₄" (32mm)
 Cord Length: 30" (762mm)

Available Colors:



E. 2120-47##
Round Translucent-Colored Plastic Clip-On Badge Reel - Spring clip w/ clear vinyl strap and no sticker
 Reel Diameter: 1¹/₄" (32mm)
 Cord Length: 30" (762mm)

Available Colors:



Square Solid-Colored

F. 2120-38##
Square Solid-Colored Plastic Clip-On Badge Reel - Slide-type belt clip w/ reinforced vinyl strap and white sticker
 Reel Dimensions: 1¹/₄" x 1¹/₄" (32 x 32mm)
 Cord Length: 30" (762mm)

Available Colors:



Call for availability on 2120-3800, 2120-3804, 2120-3805, and 2120-3809.

Smart Reel®

G. 2120-35##
Smart Reel® - "Push-Button" Round Solid-Colored Plastic Clip-On Badge Reel - Slide-type belt clip w/ reinforced vinyl strap, "Quick-Lock" system, and no sticker
 Reel Diameter: 1⁵/₁₆" (33.5mm)
 Cord Length: 36" (915mm)

Available Colors:



Call for availability on 2120-3500, 2120-3504, and 2120-3505.

Badge Reels

Attractive and convenient for displaying all IDs especially handy when the card needs to be "swiped" through a reader or scanner.



All Badge Reels shown on this page are available with one of the following: No Sticker, Silver Sticker, or White Sticker. Call for item numbers and details.

Badge Reels



Heavy-Duty

A. 2120-3300

Heavy-Duty Black/Chrome Combo Clip-On Badge Reel - Slide-type belt clip w/ reinforced vinyl strap and **nylon cord**
 Reel Diameter: 1¹/₂" (38mm)
 Cord Length: 24" (588mm)

B. 2120-3305

Heavy-Duty Black/Chrome Combo Clip-On Badge Reel - Slide-type belt clip w/ reinforced vinyl strap and **steel wire cord**
 Reel Diameter: 1¹/₂" (38mm)
 Cord Length: 24" (588mm)

C. 2120-3310

Heavy-Duty Black/Chrome Combo Clip-On Badge Reel - Slide-type belt clip w/ clear vinyl strap and **nylon wire cord**
 Reel Diameter: 1¹/₂" (38mm)
 Cord Length: 24" (588mm)

Non-Stock Item.
 Minimum Quantity May Apply.
 Call for Details.

D. 2120-3375

Heavy-Duty Black/Chrome Combo Clip-On Badge Reel - Slide-type belt clip w/ reinforced vinyl strap and **chain cord**
 Reel Diameter: 1¹/₂" (38mm)
 Cord Length: 24" (588mm)

Key

E. 2120-3325

Heavy-Duty Black/Chrome Combo Clip-On Key Reel - Slide-type belt clip w/ 1¹/₈" (28.5mm) nickel-plated steel split ring and chain cord
 Reel Diameter: 1¹/₂" (38mm)
 Cord Length: 24" (588mm)

F. 2120-3400*

Chrome-Tone Finish Steel Clip-On Key Reel - Bull-dog clip and nickel-plated steel lanyard hook
 Reel Diameter: 1" (25.5mm)
 Cord Length: 18" (457mm)
 Hook: 1¹/₂" (38mm)

*Also available:

2120-3405 - Gold-Tone Finish

Ski/Sports

G. 2120-40##

Ski/Sports Solid-Colored Plastic Reel - Flexible hook, snap closure, and no sticker
 Reel Diameter: 1³/₄" (44.5mm)
 Cord Length: 29¹/₂" (749mm)

Available Colors:



Call for availability on 2120-4000, 2120-4005, and 2120-4010.

Note: Also available with white sticker.

H. 2120-40##

Ski/Sports Solid-Colored Plastic Reel - Flexible hook, reinforced vinyl strap, and white sticker
 Reel Diameter: 1³/₄" (44.5mm)
 Cord Length: 29¹/₂" (749mm)

Available Colors:



Note: Also available with no sticker.

Plastic Hook

releases to feed through belt loop or jacket zipper.



Custom Badge Reels

Exciting NEW
Translucent-Colored
Badge Reels!



EXTEND YOUR IDENTITY
IN TWO WAYS WITH
CUSTOM BADGE REELS.



Extra
durable
reinforced
vinyl straps



RIM PRINTING

Great for company
name, phone number,
website address, and more

Protect & Preserve Your Imprint!

Clear Doming is available on all badge reels!



Standard Profile w/o
Protective Doming

Profile w/
Protective Doming

Note: Call for pricing of Doming option.

OPTIMA™ Lanyards

OPTIMA™

The First Family of Lanyards

Personalized Lanyards wear well!

Break-Away

Non Break-Away

DIAMOND SLIDER

Perfect for logos, messages, graphics, and more!

Shown with optional Clear Dome

Non Break-Away

Dye-Sub Imprintable. Up to six colors on each side.

IDENTIFICATION CAN BE STYLISH WITH CUSTOM LANYARDS!

ID Systems

Break-Away

Attractive and Comfortable... the only imprintable round lanyard on the market!

Global Airlines

Karen Warren
I.D.# 009854



OPTIMA™ Lanyards

OPTI BRAID™
The premium choice
in braided cord.

OptiBRAID™ Lanyard Material Color Chart	
YELLOW	
ORANGE	
PURPLE	
BLACK	
ROYAL BLUE	
NAVY BLUE	
GREEN	
RED	
WHITE	
BLUE/RED/BLACK	
NAVY/SPRUCE/BURGUNDY	
BLACK/BLUE/WHITE	

A. 36" (914.5mm) OptiBRAID™ Break-Away Round Woven-Nylon Lanyard -

The premium choice in braided cord. This top-quality lanyard provides both durability and a professional appearance. It is available in many different colors and can be worn with any of our imprintable OptDTACH™ detachable attachments. You can also add personalization with an imprintable OptiBRAID™ Diamond Slider (see below for details).

Note: OptiBRAID™ is only available in Break-Away styles.

B. OptiBRAID™ Diamond Sliders -

The adjustable choice in imprintable accessories. OptiBRAID™ Diamond Sliders can be added to any OptiBRAID™ Lanyard for an additional charge. They are available in plain black or can be imprinted with your company name, logo, etc. To protect and preserve an imprint, Clear Doming can also be added (see page 22).



OPTI BRAID™ Diamond Sliders
The adjustable choice in imprintable accessories.

OptiBRAID Diamond Sliders come standard with a one position imprint on black background. Also available with white background, multi-color label, and Dome.



A

A

A

B

OPTIMA™ Lanyards

OPTIKORD™

The all-round choice in imprintable neckwear.

A. 34" (863.5mm) OptiKORD™ Soft Round Lanyard -

The all-round choice in imprintable neckwear. The OptiKORD™ Lanyard is the only imprintable round lanyard on the market making it an exclusive product. This distinct lanyard can be screen-printed with any one PMS color on a variety of standard material colors. To complete your lanyard, pick from our line of imprintable OptiDTACH™ detachable attachments. An adjustable wood bead can also be added for user adjustment.

Note: OptiKORD™ is available in both break-away and non break-away styles.

Break-away feature provides a secure attachment with a special clasp that releases when tugged.

7/16" Width

Non Break-Away

OPTIFLEX™

The expandable choice in woven elastic. Available in 7/16" width.

Wood Bead

Break-Away









Non Break-Away

A

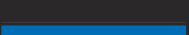
A

B

The Only Imprintable Round Lanyard on the Market!

OptiKORD™ OptiFLEX™ Lanyard Material Color Chart	
	YELLOW
	ORANGE
	PURPLE
	BLACK
	ROYAL BLUE
	NAVY BLUE
	GREEN
	RED
	WHITE
	TROPICAL*

*OptiKORD only

B. 7/16" (11mm) Wide x 38" (965mm) Long OptiFLEX™ Standard Flat Woven-Elastic Lanyard -

The expandable choice in woven elastic. This unique fabric makes the OptiFLEX™ Lanyard an attractive and comfortable way to display one's identity. It can be screen-printed with any one PMS color on a variety of standard material colors. Choose any of our imprintable OptiDTACH™ detachable attachments to personalize your lanyard.

Note: OptiFLEX™ is available in both break-away and non break-away styles.



OPTIMA™ Lanyards

OptDTACH™ Attachments - These sleek, high-tech, detachable attachments give your lanyard a contemporary and polished look. Select from six styles to add the final touch to your lanyard. For additional personalization, you can customize any of these attachments with a one-color imprint.

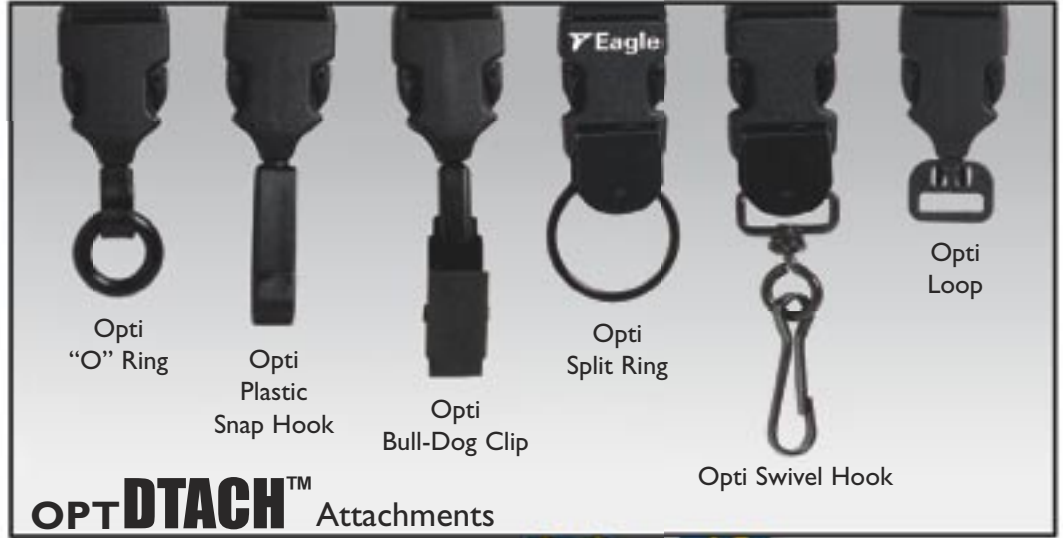

1" Width
Non Break-Away

A

3/4" Width
Break-Away

Dye-Sub Imprintable. Up To Six Colors On Each Side.
(OptiKOLOR™ can also be screen-printed)

OPTIKOLOR™
The multi-color choice in wide neckwear. Available in 5/8", 3/4", and 1" widths.

A

Add a Custom Badge Reel or Clear Vinyl Strap Clip to your Opti Loop for additional versatility.

OptiKOLOR™ Lanyard Material Color Chart	
	YELLOW
	ORANGE
	PURPLE
	BLACK
	ROYAL BLUE
	NAVY BLUE
	GREEN
	RED
	WHITE



A. OptiKOLOR™ Flat Woven-Nylon Lanyard – The multi-color choice in wide imprintable neckwear. A fashionable choice, OptiKOLOR™ Lanyards can be custom-printed using either dye sublimation or screen-printing. Dye sublimation allows for up to six imprint colors on each side. Screen-printing offers a choice of standard material colors that can be imprinted with any one PMS color. Any of our imprintable OptDTACH™ detachable attachments can be used with OptiKOLOR™ Lanyards. Furthermore, the break-away feature on this lanyard provides a secure attachment with a special clasp that releases when tugged.

Available Sizes:

- 5/8" (16mm) Wide x 34" (863.5mm) Long
- 3/4" (19mm) Wide x 34" (863.5mm) Long
- 1" (25.5mm) Wide x 34" (863.5mm) Long

Note: OptiKOLOR™ is available in both break-away and non break-away styles.

Custom Classic™ Lanyards

Classic™ LANYARDS
can be custom-printed with
logos, phone numbers, website
addresses, or other messages.
Call for details and pricing.



Classic™ Lanyards



LOGO SLIDER™
 Accent your lanyard with a customizable Logo Slider™!

5/8" Width

3/8" Width



Our Break-Away Lanyards provide a secure attachment with a unique clasp that releases when tugged.

A

B

5/8" Width

C

D

A. 2135-RND#*
 Colored 38" (965mm) Round Woven-Nylon Classic Lanyard

B. 2138-5081*
 5/8" (16mm) Stars & Stripes 35" (889mm) Break-Away Flat Woven-Nylon Classic Lanyard

Note: The Stars & Stripes Lanyard is shown with bull-dog clip and available with other attachments. Call for details and pricing.

C. 2136-####*
 5/8" (16mm) Colored 38" (965mm) Standard Flat Woven-Nylon Classic Lanyard

D. 2137-####*
 3/8" (9.5mm) Colored 35" (889mm) Break-Away Flat Woven-Nylon Classic Lanyard

Classic™
LANYARDS
 Our Traditional Lanyard Collection



Classic™ Lanyards

5/8" Width

3/8" Width

Cord Lock (optional)

A

B

C

Classic™ Lanyard Color Chart

-  Black
-  Royal Blue
-  Navy Blue
-  Red
-  White
-  Yellow
-  Green
-  Purple
-  Forest Green
-  Raspberry
-  Teal
-  Rainbow (multi-colored)
-  Orange
-  Maroon
-  Gold
-  Grey
-  Glow-in-the-Dark
-  Baby Blue
-  Brown
-  Lavender
-  Beige
-  Pink
-  ABCD*
-  Alligators*
-  Hearts*
-  Dots*
-  Red/White Check*
-  Blue/White Check*
-  Bows (multi-colored)*
-  SAFETY! It's...*
-  Ruler*
-  Apples*
-  Stars & Stripes*
-  TEMP*
-  CON*
-  VIS*
-  STA*
-  V.I.*

* Not available on Round Woven Nylon Lanyards

5/8" Width

NEW!

In-stock standard imprints now available...

- Temporary
- Contractor
- Visitor
- Staff
- V.I.P.

A. 2138-####*
5/8" (16mm)
Colored 35" (889mm)
Break-Away Flat
Woven-Nylon
Classic Lanyard

B. 2135-####*
3/8" (9.5mm)
Colored 38" (965mm)
Standard Flat Woven-Nylon
Classic Lanyard

C. 2135-5215*
5/8" (16mm) Contractor
35" (889mm)
Break-Away Flat
Woven-Nylon
Classic Lanyard

* Also available with other standard imprints (please refer to color chart) and attachments.



Classic™ Lanyard Attachments & Accessories



Adjustable Plastic Bead

Retractable Lanyard

Lanyard ribbon extends to 30"

1/4" Width

Our Retractable Lanyard provides an easy, convenient way to carry your lanyard when not worn. The front of the round case can be custom-printed.

2132-10##

Retractable Lanyard with No Sticker - Clear vinyl strap, adjustable plastic bead and 1/4" (6.5mm) ribbon extends to 30" (762mm)

* Also available:

2132-11## - White Sticker

Available Colors:



Push-Button on back releases lanyard

Note: Red, white, and blue Retractable Lanyards come with a white lanyard ribbon and bead. Black and grey Retractable Lanyards come with a black lanyard ribbon and bead.



Our Classic™ Lanyards are available with the attachments and/or accessories shown. Some combinations may require an additional cost and/or lead time. Call for details.



Classic™ Attachments

- Nickel-Plated Steel Split Ring
- Black-Oxidized Steel Split Ring
- Nickel-Plated Steel Bull-Dog Clip
- Colored Plastic O-Ring
- Nickel-Plated Steel Swivel Hook
- Black-Oxidized Steel Swivel Hook
- Plastic Slide Hook
- Plastic Clip-Eze™
- Nickel-Plated Steel Pull-Apart Key Ring
- Plastic Whistle
- Eye Glass Holder

Classic™ Accessories

LOGO SLIDERS™

Enhance your lanyard with a custom-printed Logo Slider™. Choose from our wide selection of styles!



*Available Colors:



Notes: American Flag and Smiley Face are standard designs and are not imprintable. Logo Sliders™ can be used with both classic standard and custom lanyards.



CORD LOCK (OPTIONAL)

Allows the wearer to adjust the lanyard to any length!

Card Dispensers & Badge Holders

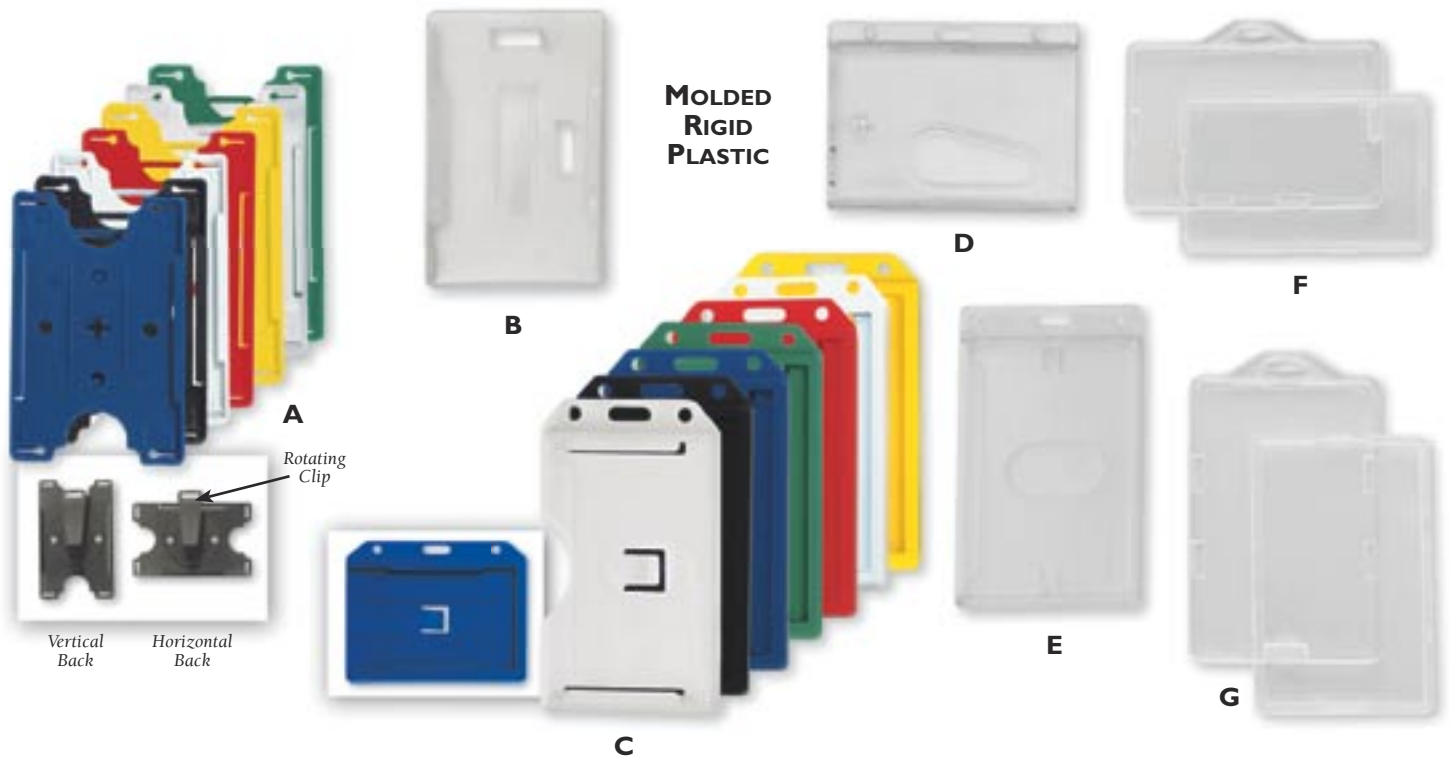

Molded Rigid Plastic

Size: Credit Card
Max. Card: 2 1/8 x 3 3/8" (54 x 86mm)

A. 1840-301#

Colored Molded Rigid Plastic Convertible Card Holder - Slot/chain holes and rotating clip for horizontal and/or vertical usage

Size: Credit Card
Max. Card: 2 1/8 x 3 3/8" (54 x 86mm)
Outside Dimensions: 2 1/4 W x 3 1/2" H (57 x 89mm)

Available Colors:



clear

B. 1840-3025

Milky-White Molded Rigid-Plastic Card Holder - Badge strap attachment hole, horiz/vert load

Size: Credit Card
Max. Card: 2 1/8 x 3 3/8" (54 x 86)
Outside Dimensions: 2 1/4 W x 3 1/2" H (57 x 89mm)

C. 1840-308#*

Colored Molded Rigid-Plastic Two-Sided Multi-Card Holder - Holds one 30 mil (750 mic) ID card on front side and three 30 mil (750 mic) ID/Prox cards or 6-8 business cards on back side. Slot/chain holes, vert/side load

Size: Credit Card
Max. Card: 2 1/8 x 3 3/8" (54 x 86mm)
Outside Dimensions: 2 3/8 W x 4 1/4" H (60 x 108mm)

Available Colors:



clear

*Also available:

1840-305# - Horizontal/Side Load

D. 1840-6000

Frosted Molded Rigid-Plastic Access Card Dispenser - Slot/chain holes, thumb notch, horiz/side load

Size: Credit Card
Max. Card: 2 1/8 x 3 3/8" (54 x 86mm)
Outside Dimensions: 2 11/16 H x 3 9/16" W (68 x 90mm)

E. 1840-6500

Frosted Molded Rigid-Plastic Access Card Dispenser - Slot/chain holes, thumb notch, vert/side load

Size: Credit Card
Max. Card: 2 1/8 x 3 3/8" (54 x 86mm)
Outside Dimensions: 2 7/16 W x 4 1/4" H (62 x 108mm)

F. 1840-6030

Locking-Plastic Proximity Card Holder - Holds two 30 mil (750 mic) cards or one 60 mil (1,500 mic) card. Rigid front cover snaps into rigid back to lock cards inside. Cards can only be removed by breaking the holder. Slot hole, horizontal

Size: Credit Card
Max. Card: 2 1/8 x 3 3/8" (54 x 86mm)
Outside Dimensions: 2 3/4 H x 3 3/4" W (70 x 95mm)

G. 1840-6035

Locking-Plastic Proximity Card Holder - Holds two 30 mil (750 mic) cards or one 60 mil (1,500 mic) card. Rigid front cover snaps into rigid back to lock cards inside. Cards can only be removed by breaking the holder. Slot hole, vertical

Size: Credit Card
Max. Card: 2 1/8 x 3 3/8" (54 x 86mm)
Outside Dimensions: 2 7/16 W x 4" H (62 x 101.5mm)

Multi-Card Holders

are the perfect solution for holding both your ID and business cards. Available in both vertical and horizontal formats and a variety of colors.



Rigid Plastic

Card Dispensers & Badge Holders won't tear, fold or bend and provide great protection for PVC ID Cards!



Card Dispensers & Badge Holders

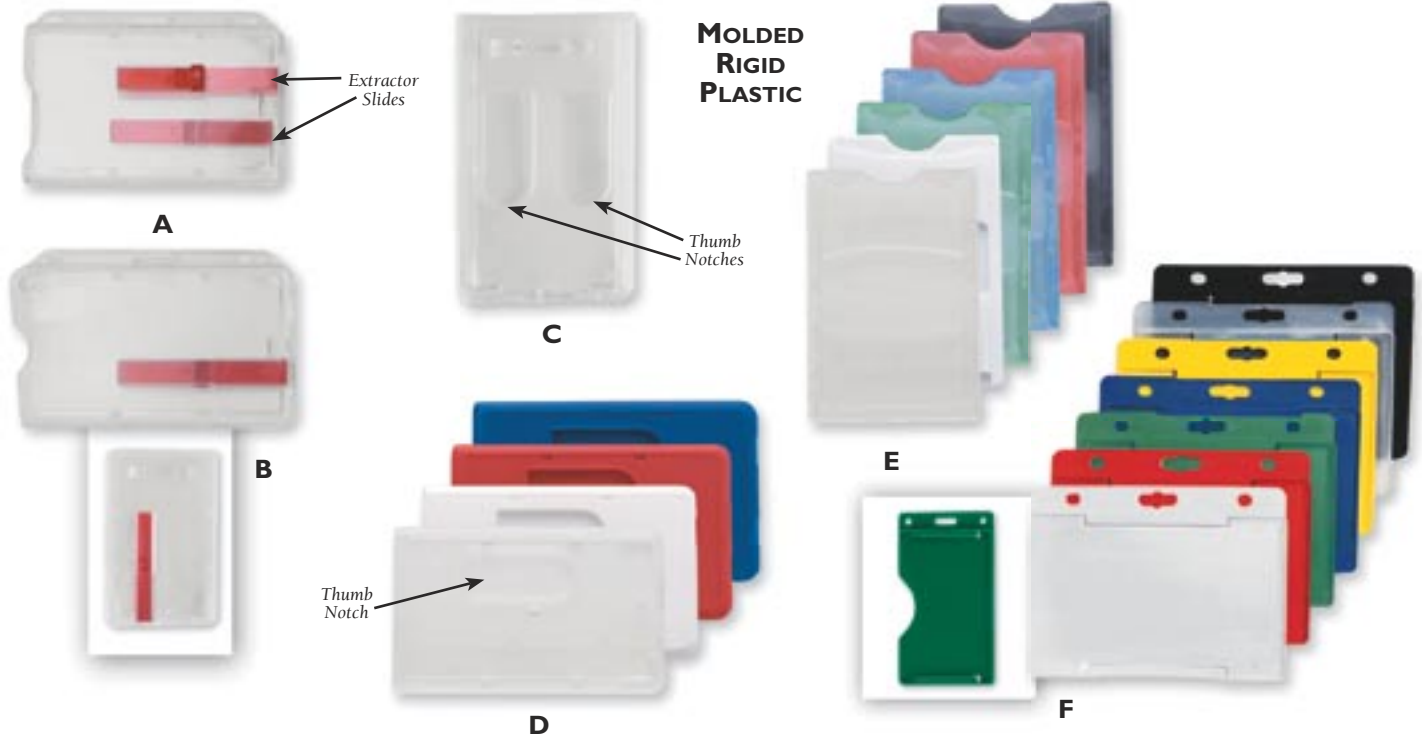

Molded Rigid Plastic

Size: Credit Card
Max. Card: 2¹/₈ x 3³/₈" (54 x 86mm)

A. 1840-6400
Frosted Molded-Polycarbonate Access Card Dispenser - Holds two 30 mil (750 mic) cards. Extractor slides on front and back sides. Ideal for chip and magnetic stripe cards. Slot/chain holes, horiz/side load
Size: Credit Card
Max. Card: 2¹/₈ x 3³/₈" (54 x 86mm)
Outside Dimensions: 2⁷/₁₆ H x 3⁵/₈" W (62 x 92mm)

B. 1840-6410*
Frosted Molded-Polycarbonate Access Card Dispenser - Holds one 30 mil (750 mic) card. Extractor slide on back side. Ideal for chip and magnetic stripe cards. Slot/chain holes, horiz/side load
Size: Credit Card
Max. Card: 2¹/₈ x 3³/₈" (54 x 86mm)
Outside Dimensions: 2⁷/₁₆ H x 3⁵/₈" W (62 x 92mm)

*Also available:

1840-6566 - Vertical/Top Load

C. 1840-6550
Frosted Molded-Polycarbonate Access Card Dispenser - Holds two 30 mil (750 mic) cards. Thumb notches on front and back sides. Ideal for chip and magnetic stripe cards. Attachment for badge strap, vert/top load
Size: Credit Card
Max. Card: 2¹/₈ x 3³/₈" (54 x 86mm)
Outside Dimensions: 2¹/₄ W x 3⁹/₁₆" H (57 x 90.5mm)

D. 1840-660#
Colored Molded-Polycarbonate Access Card Dispenser/Protector for Pocket or Purse - Holds one 30 mil (750 mic) card. The thumb notch on the front allows for easy removal of card. Ideal for chip and magnetic stripe cards. Horizontal and/or vertical usage.
Size: Credit Card
Max. Card: 2¹/₈ x 3³/₈" (54 x 86mm)
Outside Dimensions: 2¹/₄ H x 3⁹/₁₆" W (57 x 90.5mm)

Available Colors:



E. 1840-662#
Translucent-Colored Rigid-Plastic Card Dispenser/Protector for Pocket or Purse - Holds one 30 mil (750 mic) card. The opening for the thumb on the front allows for easy removal of card. Ideal for chip and magnetic stripe cards. Horizontal and/or vertical usage.
Size: Credit Card
Max. Card: 2¹/₈ x 3³/₈" (54 x 86mm)
Outside Dimensions: 2¹/₄ W x 3³/₈" H (57 x 86mm)

Available Translucent Colors:



F. 1840-810#*
Colored Molded Rigid Plastic Card Holder - Slot/chain holes, horiz/side load
Size: Credit Card
Max. Card: 2¹/₈ x 3³/₈" (54 x 86mm)
Outside Dimensions: 2⁵/₈ H x 3⁵/₈" W (67 x 92mm)

Available Colors:



*Also available:

1840-815# - Vertical/Side Load

Access Card Dispensers

Ideal for chip and magnetic swipe cards. Extractor slides allow for quick and easy removal of card.



Card Dispensers & Badge Holders

CLEAR VINYL



A



B



C



D



E

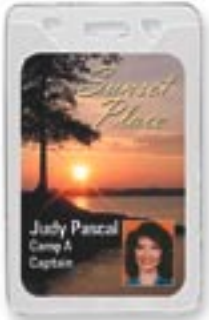

F



G



H



I

Clear Vinyl

Size: Data/Credit Card
Max. Card: 2¹/₆₄ x 3³/₈" (59 x 86mm)

A. 1810-1000* Horizontal Top-Load Clear Vinyl Badge Holder with 2-Hole Clip -

Size: Data/Credit Card
Max. Card: 2¹/₆₄ x 3³/₈" (59 x 86mm)
Outside Dimensions: 2⁹/₁₆ H x 3³/₄" W
(65 x 95mm)

*Also available:

1810-1100 - Horizontal/Side Load

B. 1810-1200 Vertical Top-Load Clear Vinyl Badge Holder with 2-Hole Clip -

Size: Data/Credit Card
Max. Card: 2¹/₆₄ x 3³/₈" (59 x 86mm)
Outside Dimensions: 2⁹/₁₆ W x 3³/₄" H
(65 x 95mm)

C. 1815-1000 Horizontal Top-Load Clear Vinyl Badge Holder with Slot/Chain Holes -

Size: Data/Credit Card
Max. Card: 2¹/₆₄ x 3³/₈" (59 x 86mm)
Outside Dimensions: 3 H x 3¹¹/₁₆" W
(76 x 93.5mm)

D. 1815-1010 Horizontal Top-Load All-Weather "Zip-Lock" Clear Vinyl Badge Holder -

Keeps out dirt and moisture
Size: Data/Credit Card
Max. Card: 2¹/₆₄ x 3³/₈" (59 x 86mm)
Outside Dimensions: 3⁵/₈ H x 4¹/₈" W
(92 x 105mm)

E. 1815-1110 Vertical Top-Load All-Weather "Zip-Lock" Clear Vinyl Badge Holder -

Keeps out dirt and moisture
Size: Data/Credit Card
Max. Card: 2¹/₆₄ x 3³/₈" (59 x 86mm)
Outside Dimensions: 3 W x 4⁷/₈" H
(76 x 124mm)

F. 1815-1100 Vertical Top-Load Clear Vinyl Badge Holder with Slot/Chain Holes -

Size: Data/Credit Card
Max. Card: 2¹/₆₄ x 3³/₈" (59 x 86mm)
Outside Dimensions: 2¹/₂ W x 4" H
(63.5 x 101.5mm)

G. 1840-1000 Horizontal Side-Load Clear Vinyl Badge Holder with Slot/Chain Holes and Tuck-In Flap -

Size: Data/Credit Card
Max. Card: 2¹/₆₄ x 3³/₈" (59 x 86mm)
Outside Dimensions: 3¹/₈ H x 3¹/₂" W
(79.5 x 89mm)

Size: Government/Military
Max. Card: 2⁵/₈ x 3⁷/₈" (66.5 x 98.5mm)

H. 1810-1400* Vertical Top-Load Clear Vinyl Badge Holder with Clip -

Size: Government/Military
Max. Card: 2⁵/₈ x 3⁷/₈" (66.5 x 98.5mm)
Outside Dimensions: 3⁵/₁₆ W x 4¹/₄" H
(84 x 108mm)

*Also available:

1810-1300 - Horizontal/Top Load

I. 1815-1200* Horizontal Top-Load Clear Vinyl Badge Holder with Slot/Chain Holes -

Size: Government/Military
Max. Card: 2⁵/₈ x 3⁷/₈" (66.5 x 98.5mm)
Outside Dimensions: 3¹/₂ H x 4¹/₄" W
(89 x 108mm)

*Also available:

1815-1300 - Vertical/Top Load

Clear Vinyl

Badge Holders provide rugged protection for all your ID credential needs. These versatile holders can be top or side loaded in both vertical and horizontal styles. They can be used with a variety of attachments including: badge clips, bar pins, strap clips, combo clips as well as neck chains, lanyards, and cords.

Card Dispensers & Badge Holders

CLEAR VINYL



COLOR-CODED VINYL



Clear Vinyl

Size: Name Badge
Max. Card: 3 x 4" (76 x 101.5mm)

A. 1815-1400
Horizontal Top-Load Clear Vinyl
Badge Holder with Slot/Chain Holes -
Size: Name Badge
Max. Card: 3 x 4" (76 x 101.5mm)
Outside Dimensions: 3⁷/₈ H x 4³/₁₆" W
(98.5 x 106.5mm)

B. 1815-1450
Vertical Top-Load Clear Vinyl
Badge Holder with Slot/Chain Holes -
Size: Name Badge
Max. Card: 3 x 4" (76 x 101.5mm)
Outside Dimensions: 3¹/₄ W x 4³/₄" H
(82.5 x 120.5mm)

C. 1815-1455
Vertical Top-Load Clear Vinyl
Badge Holder with 2-Hole Clip
and Slot/Chain Holes -
Size: Name Badge
Max. Card: 3 x 4" (76 x 101.5mm)
Outside Dimensions: 3¹/₈ W x 4¹/₁₆" H
(79.5 x 119mm)

D. 1815-1405
Horizontal Top-Load Clear Vinyl
Badge Holder with 2-Hole Clip
and Slot/Chain Holes -
Size: Name Badge
Max. Card: 3 x 4" (76 x 101.5mm)
Outside Dimensions: 3⁷/₈ H x 4³/₁₆" W
(98.5 x 106.5mm)

E. 1817-1000
Horizontal Top-Load Clear Vinyl
Name Badge Holder with Pin-Clip
Combo and Attachment Holes -
Size: Name Badge
Max. Card: 3 x 4" (76 x 101.5mm)
Outside Dimensions: 3³/₈ H x 4¹/₄" W
(86 x 108mm)

Size: Business Card
Max. Card: 2¹/₄ x 3⁷/₈" (57 x 98.5mm)

F. 1840-4130
Pressure-Sensitive Clear Vinyl
Business Card Holder -
Horizontal or vertical usage, 10 holders per sheet
Size: Business Card
Max. Card: 2¹/₄ H x 3³/₄" W (57 x 95mm)
Outside Dimensions: 2¹/₄ H x 3⁷/₈" W
(57 x 98.5mm)

Color-Coded Vinyl

Size: Data/Credit Card
Max. Card: 2²¹/₆₄ x 3³/₈" (59 x 86mm)

G. 1820-10##*
Horizontal Top-Load Color-Bar Vinyl
Badge Holder with Slot/Chain Holes -
Size: Data/Credit Card
Max. Card: 2²¹/₆₄ x 3⁵/₈" (59 x 92mm)
Outside Dimensions: 3 H x 3³/₄" W (76 x 95mm)

Available Colors:



Call for availability on 1820-1014.

*Also available:

1820-105# - Vertical/Top Load

Note: Also available in Government/Military and Extra Large sizes.

H. 1820-200#
Horizontal Top-Load Color-Back Vinyl
Badge Holder with Slot/Chain Holes -
Size: Data/Credit Card
Max. Card: 2²¹/₆₄ x 3⁵/₈" (59 x 92mm)
Outside Dimensions: 3 H x 3¹³/₁₆" W
(76 x 97mm)

Available Colors:

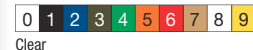

I. 1820-300#
Vertical Top-Load Color-Frame Vinyl
Badge Holder with Slot/Chain Holes -
Size: Data/Credit Card
Max. Card: 2²¹/₆₄ x 3⁵/₈" (59 x 92mm)
Outside Dimensions: 2⁷/₈ W x 4¹/₈" H
(73 x 105mm)

Available Colors:



Color-Coded

Badge Holders may be used to coordinate with your company colors or job function!

Card Dispensers & Badge Holders

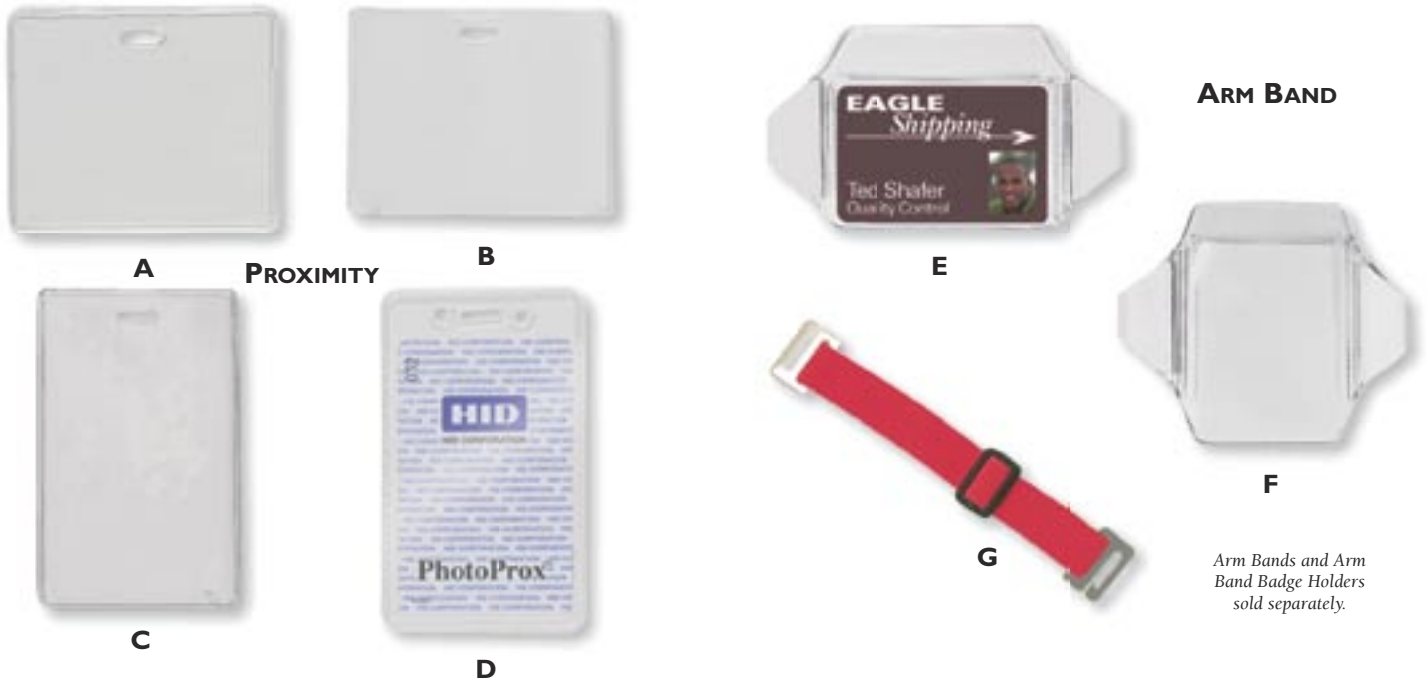

ARM BAND

Arm Bands and Arm Band Badge Holders sold separately.

Proximity

Size: Credit Card
Max. Card: 2¹/₈ x 3³/₈" (54 x 86mm)

A. 1840-5010*
Horizontal Top-Load Proximity Card Badge Holder with Slot - Clear vinyl, badge strap clip "locks in" card

Size: Credit Card
Max. Card: 2¹/₈ x 3³/₈" (54 x 86mm)
Outside Dimensions: 3 H x 4" W
(76 x 101.5mm)

*Also available:

1840-5050 - Vertical/Top Load

B. 1840-5015*
Horizontal Top-Load Proximity Card Badge Holder with Slot - Frosted-back flexible vinyl, badge strap clip "locks in" card

Size: Credit Card
Max. Card: 2¹/₈ x 3³/₈" (54 x 86mm)
Outside Dimensions: 3¹/₁₆ H x 3⁷/₈" W
(78 x 98.5mm)

*Also available:

1840-5055 - Vertical/Top Load

C. 1840-5057*
Vertical Top-Load Proximity Card Badge Holder with Slot - Clear heavy-duty vinyl, badge strap clip "locks in" card

Size: Credit Card
Max. Card: 2¹/₈ x 3³/₈" (54 x 86mm)
Outside Dimensions: 2¹¹/₁₆ W x 4³/₈" H
(68 x 111mm)

*Also available:

1840-5017 - Horizontal/Top Load

Proximity Cards

require special care and protection because of the high-tech nature of their design and their high cost-per-card. When used with strap clips or other strap attachments, the straps thread through the slots in the holder effectively "locking" the card into the holder.



D. 1840-5060*
Vertical Top-Load Proximity Card Badge Holder with Slot/Chain Holes - Clear vinyl, badge strap clip "locks in" card

Size: Credit Card
Max. Card: 2¹/₈ x 3³/₈" (54 x 86mm)
Outside Dimensions: 2¹¹/₁₆ W x 4⁷/₁₆" H
(68 x 113mm)

*Also available:

1840-5000 - Horizontal/Top Load

Arm Band

Size: Data/Credit Card
Max. Card: 2²¹/₆₄ x 3⁵/₈" (59 x 92mm)

E. 1840-7000*
Horizontal Back-Load Clear Vinyl Arm Band Badge Holder - 30 mil vinyl front and back, heavy-duty construction

Size: Data/Credit Card
Max. Card: 2²¹/₆₄ x 3⁵/₈" (59 x 92mm)
Outside Dimensions: 3¹/₂ H x 5⁷/₈" W
(89 x 149mm)

*Also available:

1840-7100 - Government/Military Size

F. 1840-7010*
Vertical Back-Load Clear Vinyl Arm Band Badge Holder - 30 mil vinyl front and back, heavy-duty construction

Size: Data/Credit Card
Max. Card: 2²¹/₆₄ x 3⁵/₈" (59 x 92mm)
Outside Dimensions: 4⁵/₁₆ W x 5" H
(109.5 x 127mm)

*Also available:

1840-7110 - Government/Military Size

G. 1840-720#
Interchangeable Arm Band - Colored 17" (432mm) adjustable elastic
Adjustment Range: 6¹/₂ - 10¹/₂"
(165 - 266.5mm)

Stretches To: 17" (432mm)

Available Colors:



Fluorescent

Card Dispensers & Badge Holders

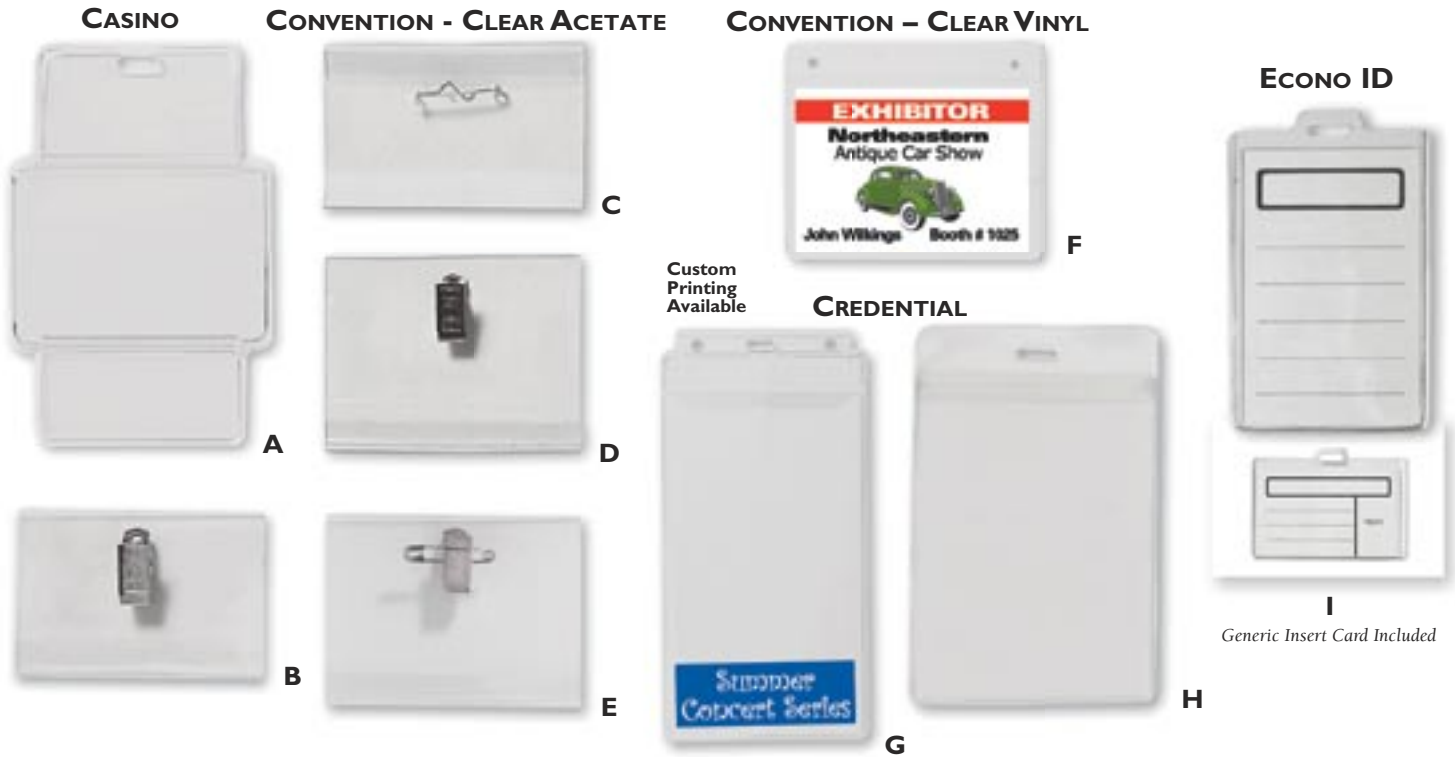

Casino (multi-pocket)

A. 1840-1560
3-Compartment Fold-Over Casino Badge Holder - Clear vinyl w/ slot hole, horiz/top load
 Max. Card: 3³/₄ x 2¹/₂" (95 x 63.5)
 Name Tag: 1¹/₈ x 2⁷/₈" (28.5 x 73mm)
 License: 2⁷/₈ x 1¹/₄" (73 x 32mm)
 Outside Dimensions: 4¹/₈ W x 6³/₁₆" H (105 x 157mm)

Convention – Clear Acetate

Size: 2¹/₄" (57mm)
 Max. Card: 2¹/₄ x 3¹/₂" (57 x 89mm)

B. 1825-2000*
2¹/₄" Convention Badge Holder - Clear acetate (10 mil) w/ nickel-plated steel embossed "U" clip
 Max. Card: 2¹/₄ x 3¹/₂" (57 x 89mm)
 Outside Dimensions: 2¹/₄ H x 3¹/₂" W (57 x 89mm)

*Also available:

1825-2005 - Pin-Clip Combo

C. 1825-2500
2¹/₄" Convention Badge Holder - Clear acetate (10 mil) w/ nickel-plated steel crimp pin
 Max. Card: 2¹/₄ x 3¹/₂" (57 x 89mm)
 Outside Dimensions: 2¹/₄ H x 3¹/₂" W (57 x 89mm)

Size: 3" (76mm)
 Max. Card: 3 x 4" (76 x 101.5mm)

D. 1825-2200*
3" Convention Badge Holder - Clear acetate (10 mil) w/ nickel-plated steel embossed "U" clip
 Max. Card: 3 x 4" (76 x 101.5mm)
 Outside Dimensions: 3 H x 4" W (76 x 101.5mm)

*Also available:

1825-2400 - Pin

E. 1825-2550
3" Convention Badge Holder - Clear acetate (10 mil) w/ nickel-plated steel pin-clip combo
 Max. Card: 3 x 4" (76 x 101.5mm)
 Outside Dimensions: 3 H x 4" W (76 x 101.5mm)

Convention Badge Holders

are used extensively at trade shows, exhibitions, conventions, business meetings, seminars, and other events.

Available with a wide variety of attachment choices, they provide a low cost, lightweight, disposable answer for the need to identify participants and attendees. Usually used with a paper insert when photos are not required.

Choose from clear acetate or vinyl material.



Convention – Clear Vinyl

F. 1815-5000
3" Convention Badge Holder - Clear vinyl (13 mil) w/ neck cord attachment holes
 Max. Card: 3 x 4" (76 x 101.5mm)
 Outside Dimensions: 3⁹/₁₆ H x 4³/₁₆" W (90.5 x 106.5mm)

Credential

G. 1840-1600
Vertical Top-Load Credential Badge Holder - Clear vinyl w/ tuck-in flap, chain holes, slits for 4" (101.5mm) badge pin
 Max. Card: 3¹⁵/₁₆ x 7³/₄" (100 x 197mm)
 Outside Dimensions: 4¹/₄ W x 8¹/₂" H (108 x 216mm)

H. 1840-1610
Vertical Top-Load Credential Badge Holder with Slot Hole - Clear vinyl, front and back pockets
 Max. Card: 3¹/₄ x 4¹/₂" (82.5 x 108mm)
 Outside Dimensions: 3³/₈ W x 5¹/₄" H (86 x 133.5mm)

Note: We offer a wide selection of Convention Badge Holders in many sizes and styles. Call for details.

Credential Badges

are perfect for sporting events, concerts, press passes, and more!



Econo ID

I. 1817-4000*
Vertical Top-Load Econo ID Badge Holder - Clear vinyl (15 mil) w/ slotted tab and generic ID card insert
 Max. Card: 2¹/₂ x 3³/₄" (63.5 x 95mm)
 Outside Dimensions: 2¹/₂ W x 4" H (63.5 x 101.5mm)

*Also available:

1817-5000 - Horizontal/Top Load

Card Dispensers & Badge Holders

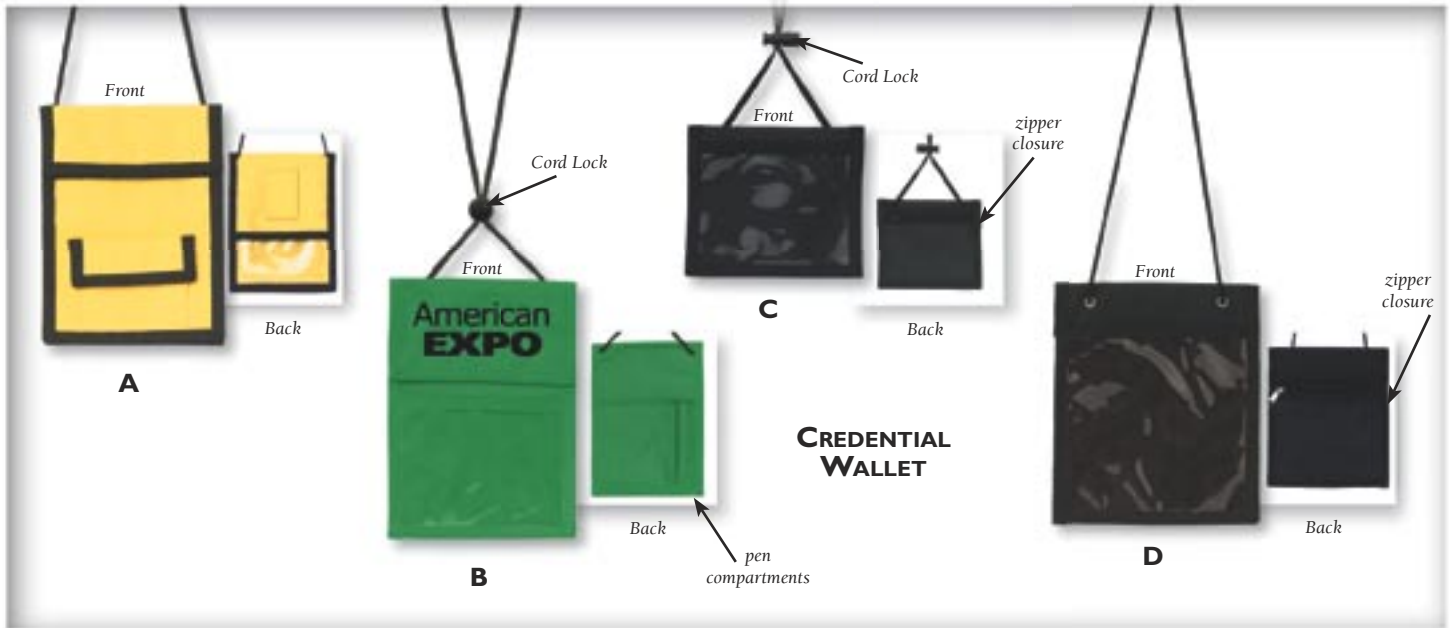

Credential Wallet

A. 1860-200#

Colored 4-Pocket Credential Wallet Holder - w/ nylon neck cord and belt loop

Front Pockets: One small nylon pocket for change and keys w/ fold-over velcro flap & two full-size nylon pockets for papers, checkbooks, pens, passport, etc. w/ fold-over velcro flap

Back Pocket: Clear vinyl pocket for ID and business cards

Cord Length: 36" (914.5mm)

Outside Dimensions: 5 W x 6⁷/₈" H
(127 x 174.5mm)

Available Colors:



Note: Cord Locks are available to adjust the length of nylon cord.

The Credential Wallet Holders on this page may be custom-printed with logos, etc. Call for details.

B. 1860-250#

Colored 3-Pocket Credential Wallet Holder with Pen Compartments - w/ nylon neck cord and adjustable cord lock

Front Pockets: One clear vinyl pocket to hold exhibitor badge & one full-size nylon pocket with fold-over velcro flap

Back Pockets: One nylon pocket for business cards and two pen compartments

Cord Length: 41" (1041.5mm)

Max. Card: 4⁷/₁₆ x 3³/₁₆" (113 x 81mm)

Outside Dimensions: 5³/₁₆ W x 7¹/₄" H
(132 x 184mm)

Available Colors:



C. 1860-260#

Colored 3-Pocket Credential Wallet Holder - w/ nylon neck cord and adjustable cord lock

Front Pocket: Clear vinyl pocket to hold exhibitor badge

Back Pockets: One open nylon pocket for papers, keys, and more and one nylon pocket w/ zipper closure to secure business cards, credit cards, cash, etc.

Cord Length: 48" (1219mm)

Max. Card: 3 x 4" (76 x 101.5mm)

Outside Dimensions: 4¹/₄ H x 4⁷/₈" W
(108 x 129mm)

Available Colors:



Call for availability on 1860-2602, 1860-2604, 1860-2606, 1860-2608, and 1860-2609.

D. 1860-400#

Colored 3-Pocket Credential Wallet Holder - w/ nylon neck cord

Front Pocket: Clear vinyl pocket to hold exhibitor badge

Back Pockets: One full-size nylon pocket w/ fold-over velcro flap to hold pens, pencils, and more and one nylon pocket w/ zipper closure to secure business cards, credit cards, cash, etc.

Cord Length: 42¹/₂" (1079.5mm)

Max. Card: 5 x 4³/₄" (127 x 120.5mm)

Outside Dimensions: 5¹¹/₁₆ W x 6³/₄" H
(144.5 x 157.5mm)

Available Colors:



Note: Cord Locks are available to adjust the length of nylon cord.

Credential Wallet Holders

Great for trade show badges, ID cards, business cards, credit cards, cash, pens and more!



Card Dispensers & Badge Holders



A



B



C



D



E



F



G



H

Magnetic

Size: Data/Credit Card
Max. Card: 2¹/₆₄ x 3³/₈" (59 x 92mm)

A. 1835-1000 Horizontal Top-Load Magnetic Badge Holder -

Size: Data/Credit Card
Max. Card: 2¹/₆₄ x 3³/₈" (59 x 86mm)
Outside Dimensions: 2³/₄ H x 3³/₈" W
(70 x 92mm)

B. 1835-1050
Horizontal Top-Load Magnetic
"Shielded" Badge Holder -
Size: Data/Credit Card
Max. Card: 2¹/₆₄ x 3³/₈" (59 x 86mm)
Outside Dimensions: 2³/₄ H x 3³/₈" W
(70 x 92mm)

Note: Shielded magnets are safe for use with magnetic stripe cards.

C. 1835-1100 Vertical Top-Load Magnetic Badge Holder -

Size: Data/Credit Card
Max. Card: 2¹/₆₄ x 3³/₈" (59 x 86mm)
Outside Dimensions: 2⁵/₈ W x 3³/₄" H
(66.5 x 95mm)

D. 1835-1110 Vertical Top-Load Magnetic Double- Pocket Badge Holder -

Size: Data/Credit Card
Max. Card: 2¹/₆₄ x 3³/₈" (59 x 86mm)
Outside Dimensions: 2⁵/₈ W x 3¹³/₁₆" H
(66.5 x 97mm)

E. 1835-1150 Vertical Top-Load Magnetic "Shielded" Badge Holder -

Size: Data/Credit Card
Max. Card: 2¹/₆₄ x 3³/₈" (59 x 86mm)
Outside Dimensions: 2⁵/₈ W x 3³/₄" H
(66.5 x 95mm)

Note: Shielded magnets are safe for use with magnetic stripe cards.

Size: 20/20
Max. Card: 2⁵/₈ x 3³/₈" (66.5 x 86mm)

F. 1835-1075 Horizontal Top-Load Magnetic Badge Holder -

Size: 20/20
Max. Card: 2⁵/₈ x 3³/₈" (66.5 x 86mm)
Outside Dimensions: 3 H x 3¹¹/₁₆" W
(76 x 93.5mm)

Size: Government/Military
Max. Card: 2⁵/₈ x 3⁷/₈" (66.5 x 98.5mm)

G. 1835-1200 Horizontal Top-Load Magnetic Badge Holder -

Size: Government/Military
Max. Card: 2⁵/₈ x 3⁷/₈" (66.5 x 98.5mm)
Outside Dimensions: 2³/₄ H x 4¹/₁₆" W
(70 x 103mm)

H. 1835-1300 Vertical Top-Load Magnetic Badge Holder -

Size: Government/Military
Max. Card: 2⁵/₈ x 3⁷/₈" (66.5 x 98.5mm)
Outside Dimensions: 3 W x 4¹/₈" H
(76 x 105mm)

Magnetic Badge Holders

To avoid damage to clothing, Magnetic Badge Holders feature two magnets. One is sealed into the front portion of the holder and one in the back. Most often attached to a breast pocket or around a belt, Magnetic Badge Holders are versatile, popular, and extremely professional in appearance.

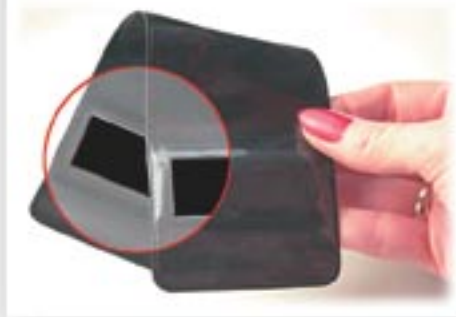

Clips, Pins, & Badge Findings

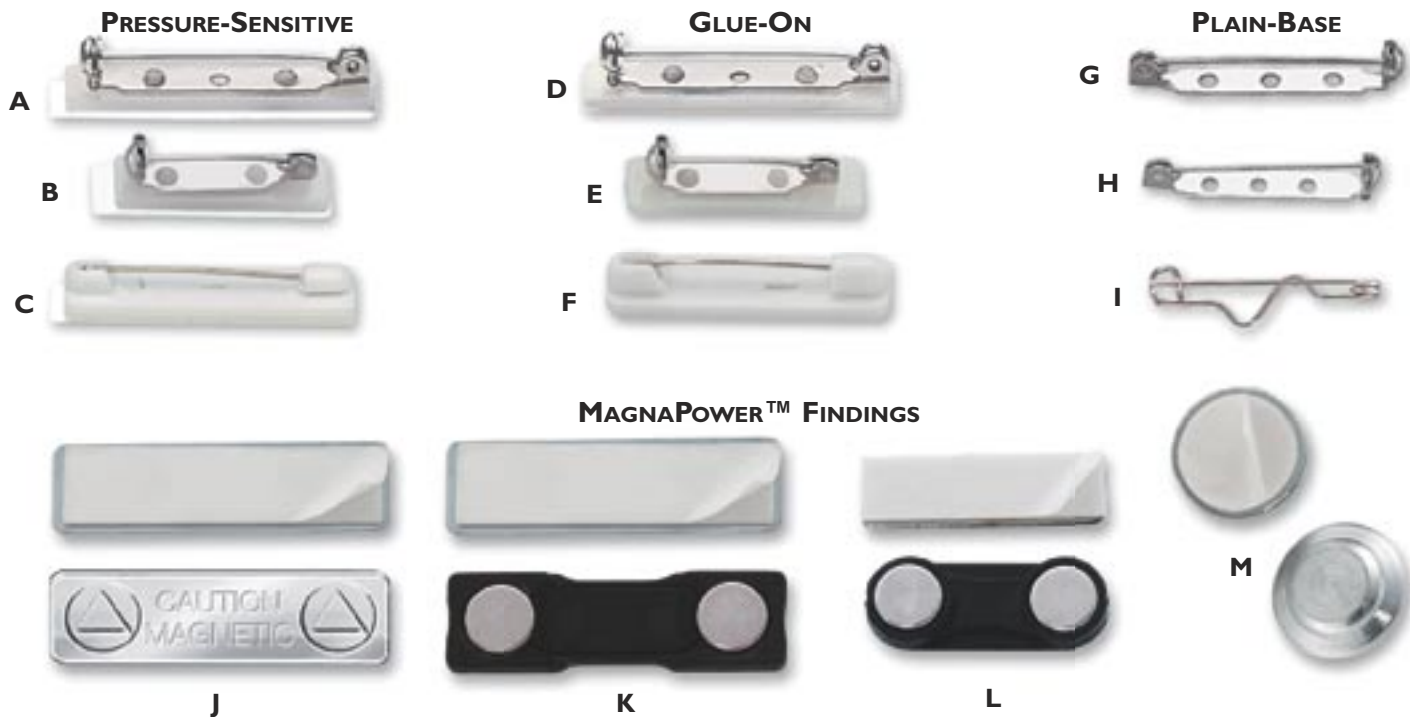

Pressure-Sensitive Bar Pins

A. 5735-1100

Pressure-Sensitive Bar Pin - 1 $\frac{1}{2}$ " (38mm)
 nickel-plated steel bar pin w/ pressure-sensitive plastic ABS base, locking safety catch, tabbed release paper, and high-bond adhesive pads
 Pad Dimensions: 1 $\frac{5}{8}$ x 1 $\frac{1}{4}$ " (41 x 6.5mm)

B. 5730-2620

Pressure-Sensitive Bar Pin - 1" (25.5mm)
 nickel-plated steel bar pin w/ pressure-sensitive plastic ABS base, locking safety catch, tabbed release paper, and high-bond adhesive pads
 Pad Dimensions: 1 $\frac{1}{8}$ x 1 $\frac{1}{4}$ " (28.5 x 6.5mm)

C. 6920-3655*

White All-Plastic Safety Pin - 1 $\frac{1}{2}$ " (38mm)
 w/ rectangular pressure-sensitive poly-styrene base, tabbed release paper, and high-bond adhesive pads
 Pad Dimensions: 1 $\frac{1}{2}$ x 1 $\frac{1}{4}$ " (38 x 6.5mm)

* Also available:

6920-3605 - 1 $\frac{1}{4}$ " White All-Plastic Safety Pin

Glue-On Bar Pins

D. 5730-2550

Glue-On Bar Pin - 1 $\frac{1}{2}$ " (38mm)
 nickel-plated steel bar pin w/ glue-on plastic ABS base and locking safety catch
 Base Dimensions: 1 $\frac{9}{16}$ x 1 $\frac{1}{4}$ " (40 x 6.5mm)

E. 5730-2570

Glue-On Bar Pin - 1" (25.5mm) nickel-plated steel bar pin w/ glue-on plastic ABS base and locking safety catch
 Base Dimensions: 1 $\frac{1}{8}$ x 1 $\frac{1}{4}$ " (28.5 x 6.5mm)

F. 6920-3650*

White All-Plastic Safety Pin - 1 $\frac{1}{2}$ " (38mm)
 w/ rectangular glue-on poly-styrene base
 Base Dimensions: 1 $\frac{1}{2}$ x 1 $\frac{1}{4}$ " (38 x 6.5mm)

* Also available:

6920-3600 - 1 $\frac{1}{4}$ " White All-Plastic Safety Pin

Plain-Base Bar Pins

G. 5730-2500

Nickel-Plated Steel Bar Pin - 1 $\frac{1}{2}$ " (38mm)
 w/ 3-hole plain-base and locking safety catch
 Hole Diameters (3): .090" (2.3mm)

H. 5730-2510

Nickel-Plated Steel Bar Pin - 1 $\frac{1}{4}$ " (32mm)
 w/ 3-hole plain-base and locking safety catch
 Hole Diameters (3): .090" (2.3mm)

I. 5730-1000

Zinc-Plated Steel Double-Lock Crimp Pin - 1 $\frac{1}{4}$ " (32mm) w/ crimp

MagnaPower™ Findings

The clothing-friendly attachment... no pin holes, no tears, no problems! The pressure-sensitive half of the set is attached to the back of your badge, the other half is placed underneath your clothing providing a secure hold.



MagnaPower™ Findings

J. 5730-3005

MagnaBadge™ Magnetic Badge Attachment - One steel plate w/ 2 round "rare-earth" magnets and one steel plate w/ pressure-sensitive foam tape
 Mounting Plate Dimensions: 1 $\frac{3}{4}$ x 1 $\frac{1}{2}$ " (44.5 x 12.5mm)

Weight: 0.5 oz

K. 5730-3010

MagnaLite™ Magnetic Badge Attachment - One ABS encased plate w/ 2 round "rare-earth" magnets and one steel plate w/ pressure-sensitive foam tape
 Mounting Plate Dimensions: 1 $\frac{3}{4}$ x 1 $\frac{1}{2}$ " (44.5 x 12.5mm)

Weight: 0.4 oz

L. 5730-3015

MagnaMini™ Magnetic Badge Attachment - One ABS encased plate w/ 2 round "rare-earth" magnets and one steel plate w/ pressure-sensitive foam tape
 Mounting Plate Dimensions: 1 $\frac{1}{4}$ x 3 $\frac{3}{8}$ " (32 x 9.5mm)

Weight: 0.3 oz

M. 5730-3030

MagnaDisc™ Magnetic Badge Attachment - One zinc-plated steel encased disc w/ 1 round "rare-earth" magnet and one steel disc w/ pressure-sensitive foam tape
 Mounting Plate Diameter: 1 $\frac{1}{16}$ " (17.5mm)
 Weight: 0.2 oz

Clips, Pins, & Badge Findings

PRESSURE-SENSITIVE



Pressure-Sensitive Clips & Pins

A. 5735-2000

1-Hole Ribbed-Face Clip -

1" (25.5mm) nickel-plated steel shank w/ fitted square base and pressure-sensitive pad
Pad Dimensions: $\frac{3}{4} \times \frac{3}{4}$ " (19 x 19mm)
Top-Hole Diameter: $\frac{3}{16}$ " (5mm)
(Old Item # - 990)

B. 5735-2010

2-Hole Clip -

1" (25.5mm) nickel-plated steel shank w/ fitted square base and pressure-sensitive pad
Pad Dimensions: $\frac{3}{4} \times \frac{3}{4}$ " (19 x 19mm)
Top-Hole Diameters (2): $\frac{1}{4}$ " (6.5mm)

C. 5735-2050

1-Hole Ribbed-Face Pin-Clip Combo -

1" (25.5mm) nickel-plated steel shank w/ safety pin, fitted square base, and pressure-sensitive pad
Pad Dimensions: $\frac{3}{4} \times \frac{3}{4}$ " (19 x 19mm)
Safety Pin Length: $1\frac{1}{2}$ " (38mm)
Top-Hole Diameter: $\frac{3}{16}$ " (5mm)
(Old Item # - 990P)

D. 5735-2100

Embossed "U" Clip -

1" (25.5mm) nickel-plated steel shank w/ fitted square base and pressure-sensitive pad
Pad Dimensions: $\frac{3}{4} \times \frac{3}{4}$ " (19 x 19mm)

E. 5735-2150

Swivel Bar Pin -

$1\frac{1}{4}$ " (32mm) nickel-plated steel pin w/ safety catch, fitted square base, and pressure-sensitive pad
Pad Dimensions: $\frac{3}{4} \times \frac{3}{4}$ " (19 x 19mm)

F. 5735-2200

Ribbed Thumb-Grip Alligator Pin-Clip Combo -

$\frac{1}{16}$ " (30mm) nickel-plated steel w/ safety pin, and pressure-sensitive pad
Pad Dimensions: $1\frac{1}{8} \times \frac{7}{16}$ " (28.5 x 11mm)
Safety Pin Length: $\frac{1}{16}$ " (30mm)

G. 5735-3008*

Ribbed Thumb-Grip Clip -

1" (25.5mm) white plastic shank w/ pressure-sensitive pad
Pad Dimensions: $\frac{7}{8} \times \frac{9}{16}$ " (22 x 14mm)

* Also available:

5735-3058 - Pin-Clip Combo

Glue-On Clips & Pins

H. 5140-1150

Small Alligator Clip -

$\frac{3}{4}$ " (19mm) nickel-plated steel shank w/ glue-on plastic ABS base
Base Dimensions: $\frac{3}{4} \times \frac{1}{2}$ " (19 x 12.5mm)

I. 5710-1058

Ribbed Thumb-Grip Pin-Clip Combo -

1" (25.5mm) white plastic shank w/ safety pin and glue-on plastic ABS base
Base Dimensions: $\frac{7}{8} \times \frac{1}{2}$ " (22 x 12.5mm)
Safety Pin Length: $\frac{1}{16}$ " (30mm)

J. 5725-2000

1-Hole Ribbed-Face Clip -

1" (25.5mm) nickel-plated steel shank w/ glue-on plastic ABS base
Base Dimensions: $\frac{3}{4} \times \frac{1}{2}$ " (19 x 12.5mm)
Top Hole Diameter: $\frac{3}{16}$ " (5mm)

K. 5725-2500

Glue-On Swivel Pin -

$1\frac{1}{4}$ " (32mm) nickel-plated steel w/ glue-on plastic ABS base
Base Dimensions: $\frac{3}{4} \times \frac{1}{2}$ " (19 x 12.5mm)

Clips and Pins

Pressure-Sensitive and Glue-On Clips and Pins attach to metal or plastic ID cards, badges, and other promotional products. Pressure-Sensitive products are ready-to-use, easy-to-apply, and feature long-term bonding characteristics. Glue-On products require an adhesive applied to the ABS base for permanent bonding.



Clips, Pins, & Badge Findings

ATTACHABLE



Attachable Clips & Pins

A. 5705-0500

I-Hole Ribbed-Face Clip -
1" (25.5mm) nickel-plated steel
shank w/ overlapping jaw
Shank-Hole Diameter: 1/8" (3mm)
Top-Hole Diameter: 3/16" (5mm)

B. 5705-1000*

2-Hole Clip - 1" (25.5mm) nickel-plated
steel shank w/ semi-overlapping jaw
Shank-Hole Diameters (2): 1/8" (3mm)
Top-Hole Diameters (2): 1/4" (6.5mm)

* Also available:

5715-1000 - Stainless Steel

C. 5705-1510

Knurled Thumb-Grip Clip -
1 5/16" (33.5mm) nickel-plated
steel shank and black rubberized tip
Shank-Hole Diameter: 1/8" (3mm)

D. 5705-3500

Embossed "U" Clip -
1 3/16" (30mm) nickel-plated steel
shank w/ overlapping jaw
Shank-Hole Diameter: 3/16" (5mm)
(Old Item # - 906)

E. 5705-3540

Embossed "U" Clip -
1 1/16" (27mm) nickel-plated steel shank
w/ overlapping jaw
Shank-Hole Diameter: 3/16" (5mm)

F. 5705-3560

I-Hole Clip - 1 3/16" (30mm) nickel-plated
steel shank w/ overlapping jaw
Shank-Hole Diameter: 3/16" (5mm)
Top-Hole Diameter: 1/4" (6.5mm)

G. 5710-1108

Ribbed Thumb-Grip "Uni-Clip" -
1 1/2" (38mm) one-piece white all-plastic
disposable (non-magnetic)

*Also available:

5710-1100 - Clear

Call for availability on 5710-1100.

I. 5735-1000

I-Hole Ribbed-Face Pin-Clip Combo -
1" (25.5mm) nickel-plated steel shank
w/ overlapping jaw and safety pin
Shank-Hole Diameter: 1/8" (3mm)
Top-Hole Diameter: 3/16" (5mm)
Safety Pin Length: 1 3/8" (35mm)

J. 5735-1050

Embossed "U" Pin-Clip Combo -
1 1/16" (27mm) nickel-plated steel shank
w/ overlapping jaw and safety pin
Shank-Hole Diameter: 3/16" (5mm)
Safety Pin Length: 1 3/8" (35mm)

K. 5735-1055

Embossed "U" Pin-Clip Combo -
1 3/16" (30mm) nickel-plated steel shank
w/ overlapping jaw and safety pin
Shank-Hole Diameter: 3/16" (5mm)
Safety Pin Length: 1 3/8" (35mm)

L. 5735-1070

I-Hole Pin-Clip Combo -
1 3/16" (30mm) nickel-plated steel shank
w/ overlapping jaw and safety pin
Shank-Hole Diameter: 3/16" (5mm)
Top-Hole Diameter: 1/4" (6.5mm)
Safety Pin Length: 1 3/8" (35mm)

Badge Clips...

are used in a wide variety of applications and can be attached by rivets or eyelets to any type of badge. They are also used with neck lanyards and other cords or straps to secure one or more items together.

H. 5725-5000*

I-Hole Ribbed-Face Pin-Clip Adaptor - 1" (25.5mm) nickel-plated steel clip w/ vinyl adaptor back for use w/ 1 1/2" (38mm) bar pin
Adaptor Back Dimensions: 7/8 x 2" (22 x 51mm)

* Also available:

5725-5100 - Small Alligator
Pin-Clip Adaptor

Key Rings, Lanyard Attachments, & Other Findings



Key Rings

A. 6920-1600

Pull-Apart Key Ring - 3¹/₄" (82.5mm) nickel-plated steel w/ two 7⁷/₈" (22mm) split rings and easy ball and socket release

B. 6920-16##

Pull-Apart Key Ring - 3¹/₄" (82.5mm) translucent-colored plastic w/ two 7⁷/₈" (22mm) nickel-plated steel split rings and easy ball and socket release

Available Colors:



C. 6920-16##

Pull-Apart Key Ring - 3¹/₄" (82.5mm) solid-colored plastic w/ two 7⁷/₈" (22mm) nickel-plated steel split rings and easy ball and socket release

Available Colors:



Split Rings

D. 6920-1000

Round-Edge Split Ring - 1" (25.5mm) nickel-plated steel, economy, non-heat treated

E. 6920-1003

Hammered-Edge Split Ring - 1" (25.5mm) nickel-plated steel, economy, non-heat treated

F. 6920-1005

Round-Edge Split Ring - 1" (25.5mm) brass-plated steel, economy, non-heat treated

G. 6920-1010

Round-Edge Split Ring - 1¹/₈" (28mm) black-oxidized steel, heat treated

SPLIT RINGS



LANYARD ATTACHMENTS



LANYARD ATTACHMENTS

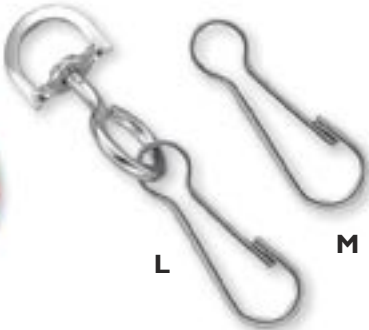
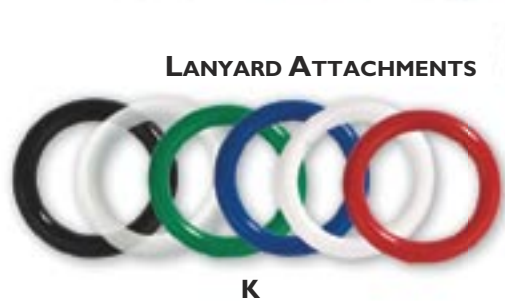

KEY-TAG TABS



Lanyard Attachments

H. 2135-4008*

White Adjustable Neck Cord Lock - Spring-loaded, slide adjuster for use with round, flat 3³/₈" (9.5mm), and flat 5⁷/₈" (16mm) lanyards

*Also available:

2135-4001 - Black

I. 5710-1151*

Black Clip-Eze™ Multi-Card Holder - Molded plastic with integrated bale to fit Universal Slide Attachment™ and other products. Allows user to wear several cards on one Clip-Eze™ attachment and easily remove each card independently. Dimensions: 1¹/₄" H x 7⁷/₁₆" W (32 x 11mm)

*Also available:

5710-1158 - White

J. 5705-3580

Embossed "U" Thumb-Grip Clip with Small Swivel Hook - 1" (25.5mm) nickel-plated steel shank w/ overlapping jaw Shank-Hole Diameter: 3³/₁₆" (5mm)

K. 6920-21##

Colored "O" Ring - 3³/₄" (9mm) round, flexible plastic

Available Colors:



L. 6920-2300

Swivel Lanyard Hook - Nickel-plated steel w/ 1³/₁₆" (30mm) textured thumb-grip hook

M. 6920-2350

Lanyard Hook - 1³/₁₆" (30mm) nickel-plated steel textured thumb-grip hook

Key-Tag Tabs

N. 5735-600#

Colored Key-Tag Tab Connector - 1³/₈" x 5⁷/₁₆" (35 x 8mm) plastic

Available Colors:

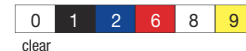

Clip-Eze™

The truly unique and convenient way to wear one or more IDs for swipe card applications.



Lanyard and Wristwear Guidelines

Dye-Sublimation

(OptiKOLOR™, Classic™ Line)

Up to Five Colors on Color Material or Six Colors on White Material

- Premium quality... durable and long lasting
- Perfect for intricate logos and detailed artwork
- Any Pantone (PMS) color ink available on 3/8", 5/8", 3/4", and 1" lanyards
- Standard two-sided printing

Notes: The appearance of the Pantone (PMS) color inks may vary when custom-printed.

Screen-Printing

(OptiKORD™, OptiFLEX™, OptiKOLOR™, Classic™ Line)

Any One PMS Color on Standard Material

- Superior quality... quick turn-around for small and large orders
- Any one Pantone (PMS) color ink on 3/8", 5/8", 3/4", 7/16", and 1" lanyards - each side can be a different color
- One or two-sided printing available - consider using different imprints on each side
- Best suited for straight text and simple logos

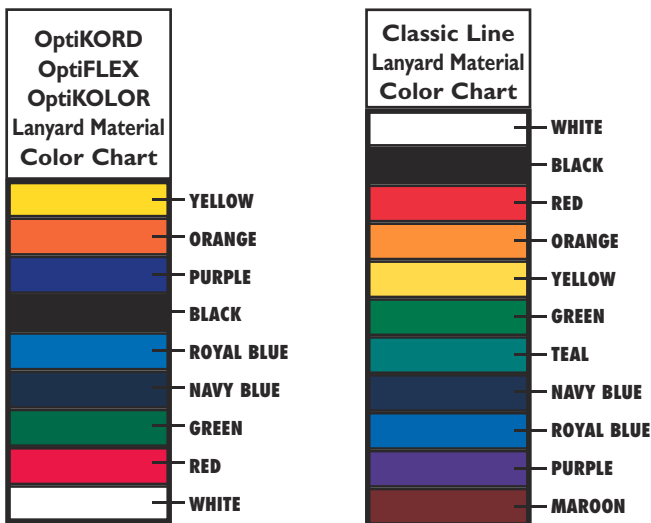

Notes: The appearance of the Pantone (PMS) color inks may vary based on the actual color of the lanyard material.

Due to the nature of this printing process, there are limitations with certain color combinations and image resolution. Your account executive can assist you with any questions.

Hot Stamping

One Color or Two Colors (Side-by-Side Printing) on Standard Material

- Good quality... perfect choice for limited budgets
- Best suited for straight text
- Great for give-aways and promotions
- Available in color combinations shown below – multi-color imprints available as well
- One or two-sided printing available on 3/8", 5/8", 3/4", and 1" lanyards – consider different images or imprint colors on each side

Imprint Colors (on Standard Lanyard Material)



Maximum Print Areas

Dye-Sublimation - (3/8") 15 x 3/16", (5/8") 15 x 7/16", (3/4) 15 x 5/8", (1") 15 x 7/8"

Screen-Printing - (3/8") 15 x 3/16", (7/16" - OptiFLEX only) 13 x 3/8", (5/8") 15 x 7/16", (3/4") 15 x 5/8", (1") 15 x 7/8"

Hot Stamping - (3/8") 6 x 3/16", (5/8") 6 x 7/16", (3/4") 6 x 5/8", (1") 6 x 7/8"

• Minimum Stroke Thickness - .055"

• Suggested Fonts – Sans Serifs (i.e. Arial, Tahoma)

OptiBRAID Diamond Slider - 3/4 x 3/4"

Detachable Buckle (OPTIMA™ Line only) - 1/2 x 1/4"

Logo Sliders (Classic™ Line only) - 3/4" diameter

Minimum Production Run

Short-Run Dye-Sublimation - 100-piece minimum

Dye-Sublimation - 1000-piece minimum

Screen-Printing - 250-piece minimum

Hot Stamping (Classic™ Line only) - 100-piece minimum

Lead Time

Short-Run Dye-Sublimation - 1-2 weeks

Dye-Sublimation - 3-5 weeks

Screen-Printing - 1-3 weeks

Hot Stamping - 1-2 weeks

Note: The schedules outlined above, indicate the estimated lead time following receipt of approval of artwork proofs.

Packaging

Lanyards are bundled in polybags of 100. Additional charges may apply for other quantities or special requests. Call for quote.